

Content

■ HKS 100 S and HKS 160 S

1.1 Introduction.....	2
1.2 Accessories complete set options HKS 100 S and HKS 160 S	7
1.3 Profile-related elements	27

Range of application HKS 100 S and HKS 160 S

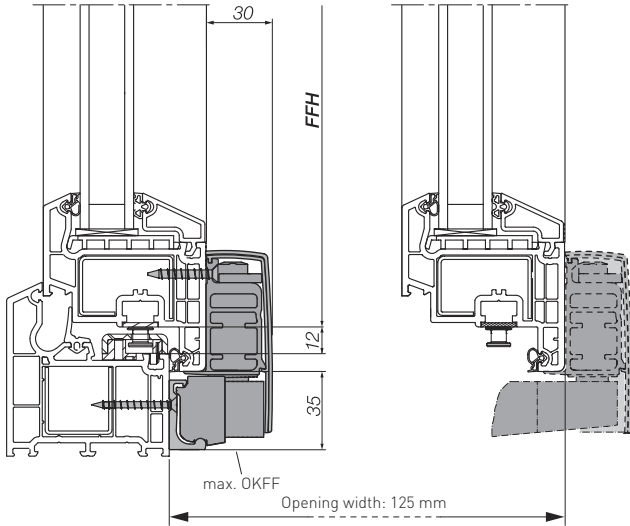

Vertical section ATRIUM HKS 100 S PVC

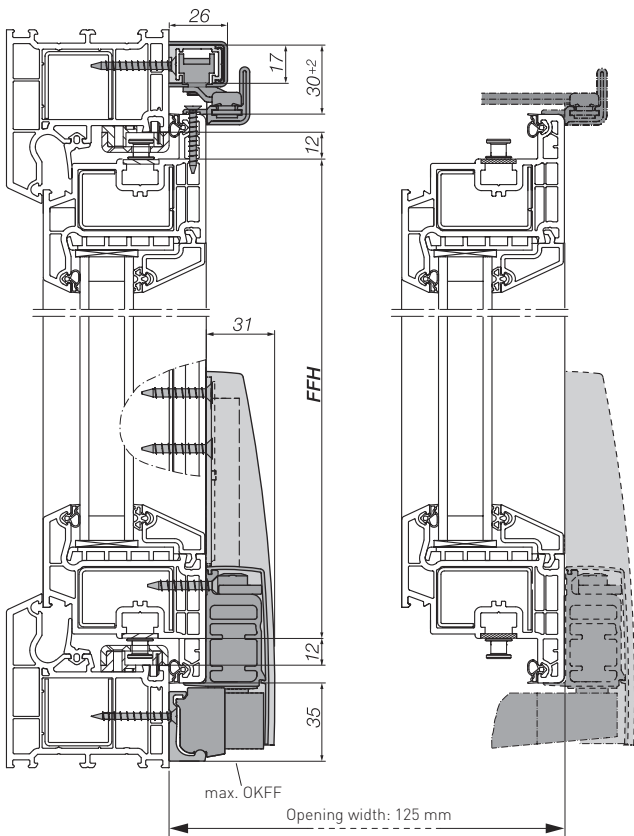

Vertical section ATRIUM HKS 160 S PVC



Range of application HKS 100 S

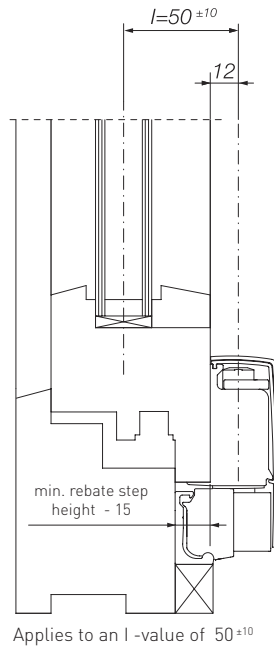
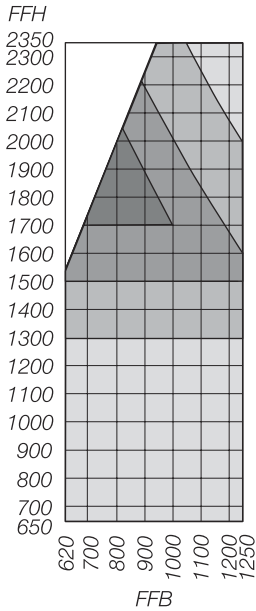

Sash rebate width (FFB).....620-1250 mm
 Sash rebate height (FFH)650-2250 mm
 Sash weightmax. 100 kg

Range of application HKS 160 S

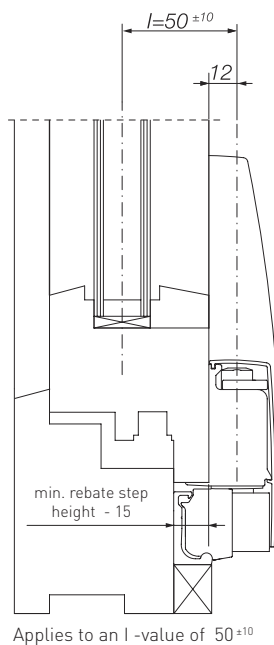
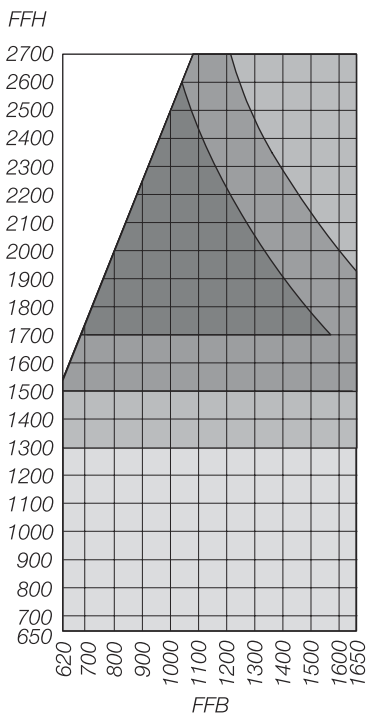

Sash rebate width (FFB).....620-1650 mm
 Sash rebate height (FFH)650-2700 mm
 Sash weightmax. 160 kg

FFH : FFB = max. 2,5 : 1

The borders of a scope specified here are obligatory and should not be exceeded. Besides, adhere to admissible parameters of application, instructions and guidelines on processing of profiles' producers.

Positions and possible options of a sash's opening

Frames with solid glazing or side hung sashes

Schemes A, G , K, and C

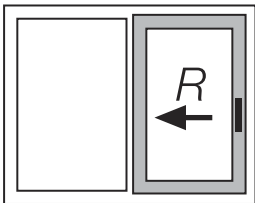

Scheme A
 Two-part element:
 1 Sliding sash (left or right)

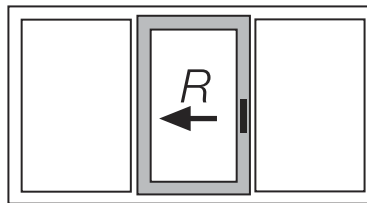

Scheme G
 Three-part element:
 1 Sliding sash (left or right)

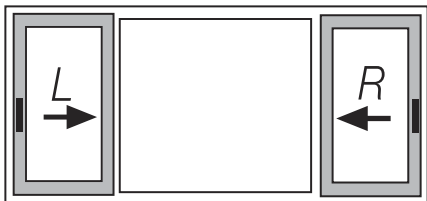

Scheme K
 Three-part element:
 2 Sliding sashes (left and right)

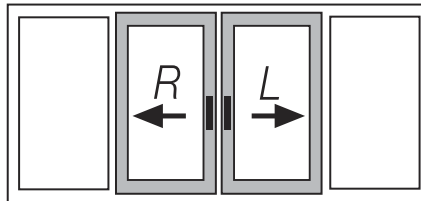

Scheme C
 Four-part element:
 2 sliding sashes (left and right) with mounting mullion between HKS elements

Scheme C*
 Four-part element:
 2 sliding sashes (left and right), without mounting mullion between HKS elements

Accessories set (schemes K and C, double quantity)

- 1 basic carton
- 1 handle
- 1 package of locking plates (profile-related)
- 1 profile set of normal size
- 1 horizontal locking
- 1 vertical locking

Accessories set scheme C*

- 1 basic carton forend (loose post)
- 2 handles
- 1 package of strikers (profile-related)
- 2 profile sets of normal size
- 2 horizontal locking
- 2 vertical locking

Brief description

HKS 100 S

Tilting and sliding hardware HKS 100 S with basic safety WK1.

For door and window elements made of plastic (PVC), with a sash's weight up to 100 kg. The tying-around of a sash (sash's elements, namely vertical and horizontal locking) consists of a gear, middle connections and corner transmissions. The top node of sliding stay arm is separated from the main locking.

The shock-proof safety lock on both brackets of stay arm.

Bogies with cleaning brushes for cleaning of bottom bearing track.

Sliding sash adjustable by height adjustment.

Upper guide track with PVC cover profile.

Flat aluminium bogie cover (28 mm).

HKS 160 S

Tilting and sliding hardware HKS 160 S with basic safety WK1, with the possibility of equipping up to WK2.

For door and window elements made of plastic (PVC), with a sash's weight up to 160 kg. The tying-around of sash (sash's elements, namely vertical and horizontal locking) consists of a gear, middle connections and corner transmissions. The top node of sliding stay arm is separated from the main locking.

The shock-proof safety lock on both brackets of stay arm.

Bogies with cleaning brushes for cleaning of bottom bearing track.

Sliding sash adjustable by height adjustment.

Upper guide track with PVC cover profile.

Flat aluminium bogie cover (28 mm).

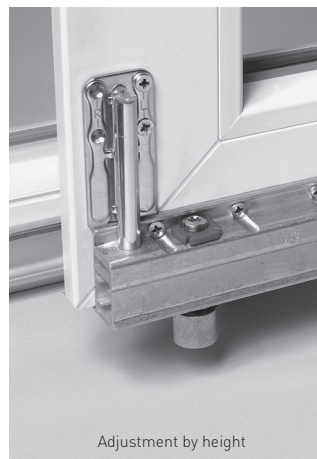



HKS 100 S, Standard, width up to 750 mm

Scheme A, PVC profile

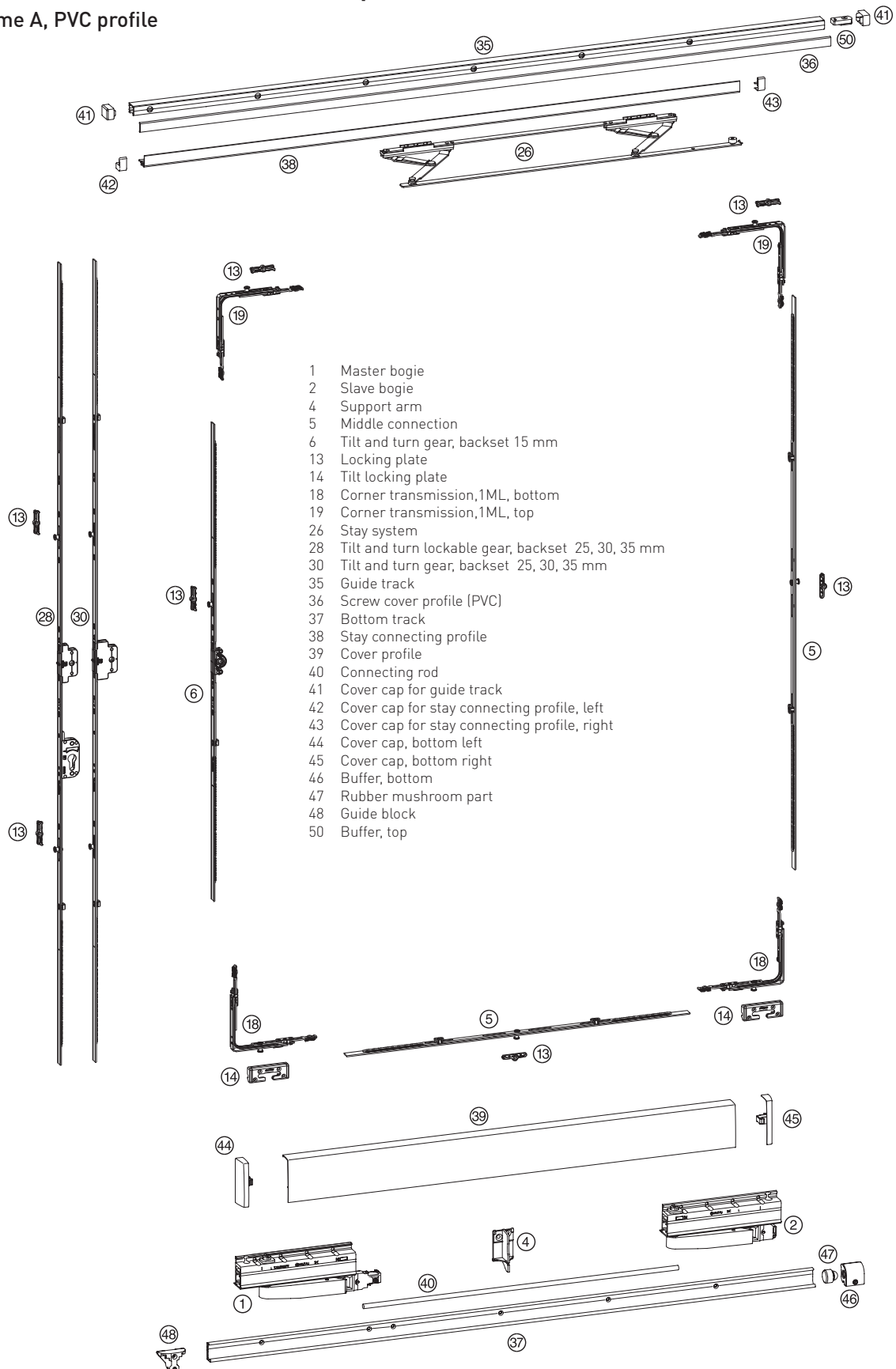

- 1 Master bogie
- 2 Slave bogie
- 4 Support arm
- 5 Middle connection
- 6 Tilt and turn gear, backset 15 mm
- 13 Locking plate
- 14 Tilt locking plate
- 18 Corner transmission,1ML, bottom
- 19 Corner transmission,1ML, top
- 26 Stay system
- 28 Tilt and turn lockable gear, backset 25, 30, 35 mm
- 30 Tilt and turn gear, backset 25, 30, 35 mm
- 35 Guide track
- 36 Screw cover profile (PVC)
- 37 Bottom track
- 38 Stay connecting profile
- 39 Cover profile
- 40 Connecting rod
- 41 Cover cap for guide track
- 42 Cover cap for stay connecting profile, left
- 43 Cover cap for stay connecting profile, right
- 44 Cover cap, bottom left
- 45 Cover cap, bottom right
- 46 Buffer, bottom
- 47 Rubber mushroom part
- 48 Guide block
- 50 Buffer, top

Figure fitting parts = design left (according to DIN EN 12519 opening to the right)



Accessories complete set options

HKS 100 S, Standard, width up to 750 mm

Scheme A, PVC profile

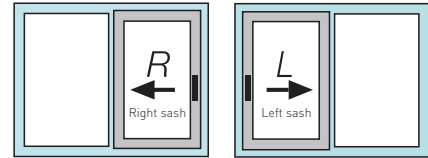

Item on the pic.		left	right			
1,2	Bogies kit HKS 100 S	I7002-00-L03	I7002-00-R03			
4, 26, 35, 36, 37, 39, 40, 41, 46, 47, 48, 50	Profile set + stay system HKS 100 S	FFB	RAB	white	brown	
		620-900	1930	I7004-01-N01	I7004-01-N02	
	The tying-around of a sash (vertical and horizontal locking)	FFB	FFH	Part number		
5	Middle connection L = 520	551-750	-	S4005-05-N03		
	Middle connection L = 720	751-950	-	S4005-07-N03		
	Middle connection L = 1200	951-1430	-	S4005-12-N03		
	Middle connection L = 1680	1431-1910	-	S4005-17-N03		
	Middle connection L = 2160	1911-2390	-	S4005-22-N03		
6	Gear 0, L=320, 450-550, backset 15 mm	-	450-550	S1001-02-N03		
	Gear 1, L=520, 551-750, backset 15 mm	-	551-750	S1001-04-N03		
	Gear 2, L=1000, 751-1230, 1 ML, backset 15 mm	-	751-1230	S1001-09-N03		
	Gear 3, L=1200, 950-1430, 1 ML, backset 15 mm	-	950-1430	S1001-11-N03		
	Gear 4, L=1480, 1231-1710, 2 ML, backset 15 mm	-	1231-1710	S1001-15-N03		
	Gear 5, L=1680, 1431-1910, 2 ML, backset 15 mm	-	1431-1910	S1001-16-N03		
	Gear 6, L=2160, 1911-2390, 3 ML, backset 15 mm	-	1911-2390	S1001-21-N03		
13	Locking plate	-	-	(profile-related) see profile overview		
14	Tilt locking plate	-	-	(profile-related) see profile overview		
18	Corner transmission, bottom	400-1280	450-2390	S2006-00-N03		
19	Corner transmission standard	400-1280	450-2390	S2001-00-N03		
28	Gear variable L= 1610, 1431-1910, 2 ML, backset 25 mm, lockable	-	1431-1910	S1006-16-N03		
	Gear variable L= 2090, 1911-2390, 3 ML, backset 25 mm, lockable	-	1911-2390	S1006-21-N03		
	Gear variable L= 1610, 1431-1910, 2 ML, backset 30 mm, lockable	-	1431-1910	S1008-16-N03		
	Gear variable L= 2090, 1911-2390, 3 ML, backset 30 mm, lockable	-	1911-2390	S1008-21-N03		
	Gear variable L= 1610, 1431-1910, 2 ML, backset 35 mm, lockable	-	1431-1910	S1010-16-N03		
	Gear variable L= 2090, 1911-2390, 3 ML, backset 35 mm, lockable	-	1911-2390	S1010-21-N03		
	Gear variable L= 1610, 1431-1910, 2 ML, backset 25 mm*, lockable	-	1431-1910	S1012-16-N03		
	Gear variable L= 2090, 1911-2390, 3 ML, backset 25 mm*, lockable	-	1911-2390	S1012-21-N03		
	Gear variable L= 1610, 1431-1910, 2 ML, backset 30 mm*, lockable	-	1431-1910	S1014-16-N03		
	Gear variable L= 2090, 1911-2390, 3 ML, backset 30 mm*, lockable	-	1911-2390	S1014-21-N03		
	Gear variable L= 1610, 1431-1910, 2 ML, backset 35 mm*, lockable	-	1431-1910	S1016-16-N03		
	Gear variable L= 2090, 1911-2390, 3 ML, backset 35 mm*, lockable	-	1911-2390	S1016-21-N03		
	30	Gear variable L= 1610, 1431-1910, 2 ML, backset 25 mm	-	1431-1910	S1005-16-N03	
		Gear variable L= 2090, 1911-2390, 3 ML, backset 25 mm	-	1911-2390	S1005-21-N03	
Gear variable L= 1610, 1431-1910, 2 ML, backset 30 mm		-	1431-1910	S1007-16-N03		
Gear variable L= 2090, 1911-2390, 3 ML, backset 30 mm		-	1911-2390	S1007-21-N03		
Gear variable L= 1610, 1431-1910, 2 ML, backset 35 mm		-	1431-1910	S1009-16-N03		
Gear variable L= 2090, 1911-2390, 3 ML, backset 35 mm		-	1911-2390	S1009-21-N03		
Gear variable L= 1610, 1431-1910, 2 ML, backset 25 mm*		-	1431-1910	S1011-16-N03		
Gear variable L= 2090, 1911-2390, 3 ML, backset 25 mm*		-	1911-2390	S1011-21-N03		
Gear variable L= 1610, 1431-1910, 2 ML, backset 30 mm*		-	1431-1910	S1013-16-N03		
Gear variable L= 2090, 1911-2390, 3 ML, backset 30 mm*		-	1911-2390	S1013-21-N03		
Gear variable L= 1610, 1431-1910, 2 ML, backset 35 mm*		-	1431-1910	S1015-16-N03		
Gear variable L= 2090, 1911-2390, 3 ML, backset 35 mm*		-	1911-2390	S1015-21-N03		



HKS 100 S, Standard, width up to 1250 mm

Scheme A, PVC profile

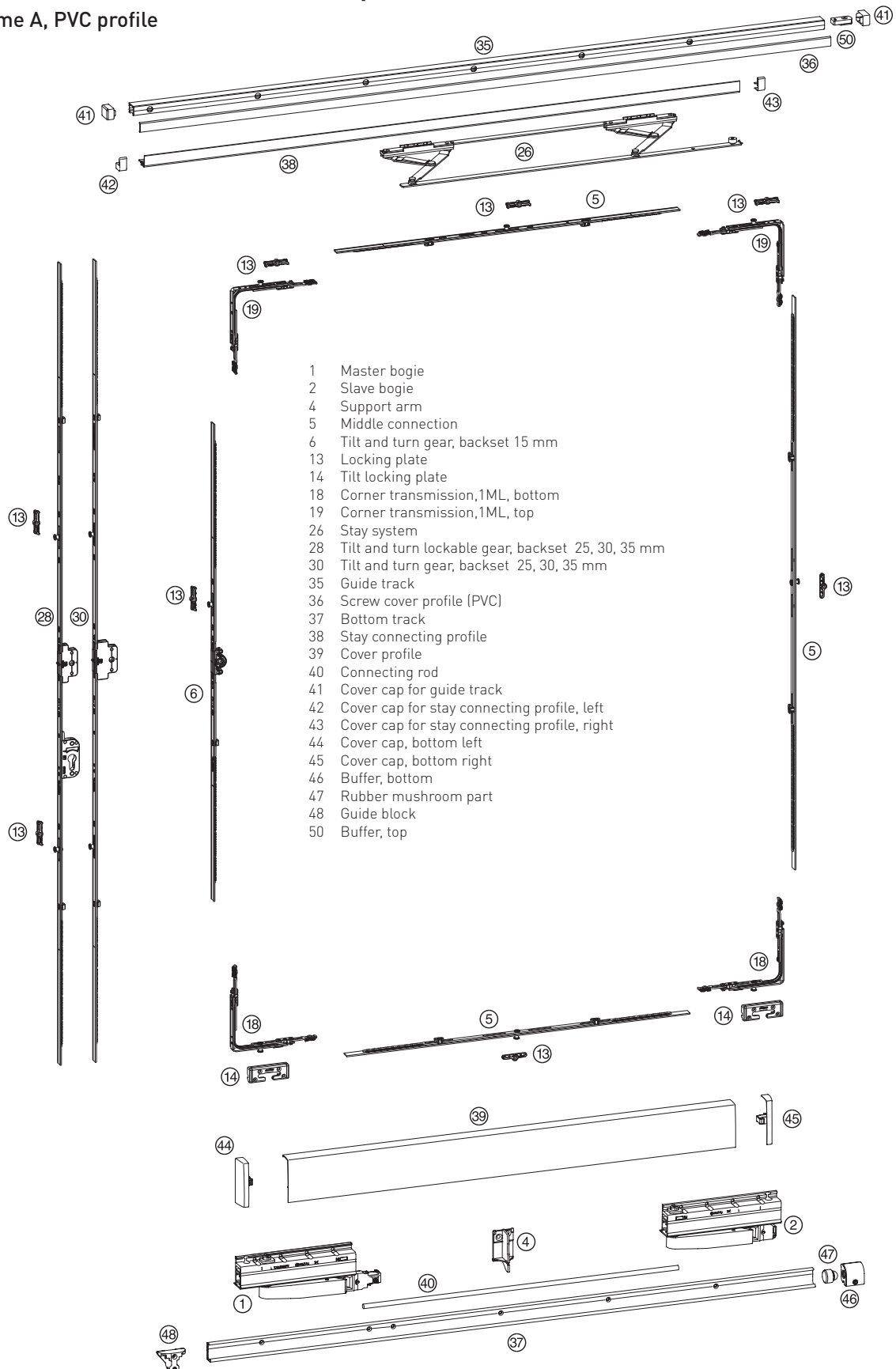
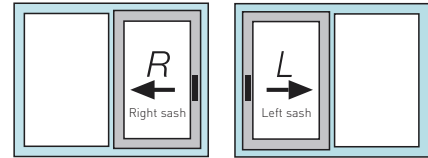

Figure fitting parts = design left (according to DIN EN 12519 opening to the right)



HKS 100 S, Standard, width up to 1250 mm

Scheme A, PVC profile



Item on the pic.		left	right		
1,2	Bogies kit HKS 100 S	I7002-00-L03	I7002-00-R03		
4, 26, 35, 36, 37, 39, 40, 41, 46, 47, 48, 50	Profile set + stay system HKS 100 S	FFB 620-900 901-1050 1051-1250	RAB 1930	white I7004-01-N01 I7004-02-N01 I7004-03-N01	brown I7004-01-N02 I7004-02-N02 I7004-03-N02
	The tying-around of a sash (vertical and horizontal locking)	FFB	FFH	Part number	
5	Middle connection L = 520	551-750	-	S4005-05-N03	
	Middle connection L = 720	751-950	-	S4005-07-N03	
	Middle connection L = 1200	951-1430	-	S4005-12-N03	
	Middle connection L = 1680	1431-1910	-	S4005-17-N03	
	Middle connection L = 2160	1911-2390	-	S4005-22-N03	
6	Gear 0, L=320, 450-550, backset 15 mm	-	450-550	S1001-02-N03	
	Gear 1, L=520, 551-750, backset 15 mm	-	551-750	S1001-04-N03	
	Gear 2, L=1000, 751-1230, 1 ML, backset 15 mm	-	751-1230	S1001-09-N03	
	Gear 3, L=1200, 950-1430, 1 ML, backset 15 mm	-	950-1430	S1001-11-N03	
	Gear 4, L=1480, 1231-1710, 2 ML, backset 15 mm	-	1231-1710	S1001-15-N03	
	Gear 5, L=1680, 1431-1910, 2 ML, backset 15 mm	-	1431-1910	S1001-16-N03	
	Gear 6, L=2160, 1911-2390, 3 ML, backset 15 mm	-	1911-2390	S1001-21-N03	
13	Locking plate	-	-	(profile-related) see profile overview	
14	Tilt locking plate	-	-	(profile-related) see profile overview	
18	Corner transmission, bottom	400-1280	450-2390	S2006-00-N03	
19	Corner transmission standard	400-1280	450-2390	S2001-00-N03	
28	Gear variable L= 1610, 1431-1910, 2 ML, backset 25 mm, lockable	-	1431-1910	S1006-16-N03	
	Gear variable L= 2090, 1911-2390, 3 ML, backset 25 mm, lockable	-	1911-2390	S1006-21-N03	
	Gear variable L= 1610, 1431-1910, 2 ML, backset 30 mm, lockable	-	1431-1910	S1008-16-N03	
	Gear variable L= 2090, 1911-2390, 3 ML, backset 30 mm, lockable	-	1911-2390	S1008-21-N03	
	Gear variable L= 1610, 1431-1910, 2 ML, backset 35 mm, lockable	-	1431-1910	S1010-16-N03	
	Gear variable L= 2090, 1911-2390, 3 ML, backset 35 mm, lockable	-	1911-2390	S1010-21-N03	
	Gear variable L= 1610, 1431-1910, 2 ML, backset 25 mm*, lockable	-	1431-1910	S1012-16-N03	
	Gear variable L= 2090, 1911-2390, 3 ML, backset 25 mm*, lockable	-	1911-2390	S1012-21-N03	
	Gear variable L= 1610, 1431-1910, 2 ML, backset 30 mm*, lockable	-	1431-1910	S1014-16-N03	
	Gear variable L= 2090, 1911-2390, 3 ML, backset 30 mm*, lockable	-	1911-2390	S1014-21-N03	
	Gear variable L= 1610, 1431-1910, 2 ML, backset 35 mm*, lockable	-	1431-1910	S1016-16-N03	
	Gear variable L= 2090, 1911-2390, 3 ML, backset 35 mm*, lockable	-	1911-2390	S1016-21-N03	
30	Gear variable L= 1610, 1431-1910, 2 ML, backset 25 mm	-	1431-1910	S1005-16-N03	
	Gear variable L= 2090, 1911-2390, 3 ML, backset 25 mm	-	1911-2390	S1005-21-N03	
	Gear variable L= 1610, 1431-1910, 2 ML, backset 30 mm	-	1431-1910	S1007-16-N03	
	Gear variable L= 2090, 1911-2390, 3 ML, backset 30 mm	-	1911-2390	S1007-21-N03	
	Gear variable L= 1610, 1431-1910, 2 ML, backset 35 mm	-	1431-1910	S1009-16-N03	
	Gear variable L= 2090, 1911-2390, 3 ML, backset 35 mm	-	1911-2390	S1009-21-N03	
	Gear variable L= 1610, 1431-1910, 2 ML, backset 25 mm*	-	1431-1910	S1011-16-N03	
	Gear variable L= 2090, 1911-2390, 3 ML, backset 25 mm*	-	1911-2390	S1011-21-N03	
	Gear variable L= 1610, 1431-1910, 2 ML, backset 30 mm*	-	1431-1910	S1013-16-N03	
	Gear variable L= 2090, 1911-2390, 3 ML, backset 30 mm*	-	1911-2390	S1013-21-N03	
	Gear variable L= 1610, 1431-1910, 2 ML, backset 35 mm*	-	1431-1910	S1015-16-N03	
	Gear variable L= 2090, 1911-2390, 3 ML, backset 35 mm*	-	1911-2390	S1015-21-N03	

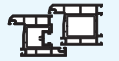

HKS 100 S, RC1 (WK1) - RC3 (WK3), width up to 1250 mm

Scheme A, PVC profile

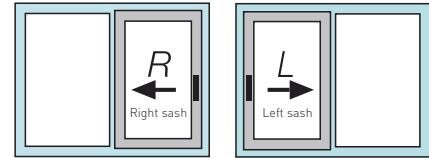

Figure fitting parts = design left (according to DIN EN 12519 opening to the right)



HKS 100 S, RC1 (WK1) - RC3 (WK3)

Scheme A, PVC profile



Item on the pic.		left	right			
1,2	Bogies kit HKS 100 S	I7002-00-L03	I7002-00-R03			
4, 26, 35, 36, 37, 39, 40, 41, 46, 47, 48, 50	Profile set + stay system HKS 100 S	FFB 620-900 901-1050 1051-1250	RAB 1930	white I7004-01-N01 I7004-02-N01 I7004-03-N01	brown I7004-01-N02 I7004-02-N02 I7004-03-N02	
	The tying-around of a sash (vertical and horizontal locking)	FFB	FFH	Part number		
5	Middle connection L = 520	551-750	-	S4005-05-N03		
	Middle connection L = 720	751-950	-	S4005-07-N03		
	Middle connection L = 1200	951-1430	-	S4005-12-N03		
	Middle connection L = 1680	1431-1910	-	S4005-17-N03		
	Middle connection L = 2160	1911-2390	-	S4005-22-N03		
6	Gear 0, L=320, 450-550, backset 15 mm	-	450-550	S1001-02-N03		
	Gear 1, L=520, 551-750, backset 15 mm	-	551-750	S1001-04-N03		
	Gear 2, L=1000, 751-1230, 1 ML, backset 15 mm	-	751-1230	S1001-09-N03		
	Gear 3, L=1200, 950-1430, 1 ML, backset 15 mm	-	950-1430	S1001-11-N03		
	Gear 4, L=1480, 1231-1710, 2 ML, backset 15 mm	-	1231-1710	S1001-15-N03		
	Gear 5, L=1680, 1431-1910, 2 ML, backset 15 mm	-	1431-1910	S1001-16-N03		
	Gear 6, L=2160, 1911-2390, 3 ML, backset 15 mm	-	1911-2390	S1001-21-N03		
13	Locking plate	-	-	(profile-related) see profile overview		
14	Tilt locking plate	-	-	(profile-related) see profile overview		
15	Safety lockig plate	-	-	(profile-related) see profile overview		
18	Corner transmission, bottom	400-1280	450-2390	S2006-00-N03		
19	Corner transmission standard	400-1280	450-2390	S2001-00-N03		
20	Corner transmission, 2ML, bottom	400-1280	450-2390	S2007-00-N03		
21	Corner transmission, 2ML, top	400-1280	450-2390	S2002-00-N03		
28	Gear variable L= 1610, 1431-1910, 2 ML, backset 25 mm, lockable	-	1431-1910	S1006-16-N03		
	Gear variable L= 2090, 1911-2390, 3 ML, backset 25 mm, lockable	-	1911-2390	S1006-21-N03		
	Gear variable L= 1610, 1431-1910, 2 ML, backset 30 mm, lockable	-	1431-1910	S1008-16-N03		
	Gear variable L= 2090, 1911-2390, 3 ML, backset 30 mm, lockable	-	1911-2390	S1008-21-N03		
	Gear variable L= 1610, 1431-1910, 2 ML, backset 35 mm, lockable	-	1431-1910	S1010-16-N03		
	Gear variable L= 2090, 1911-2390, 3 ML, backset 35 mm, lockable	-	1911-2390	S1010-21-N03		
	Gear variable L= 1610, 1431-1910, 2 ML, backset 25 mm*, lockable	-	1431-1910	S1012-16-N03		
	Gear variable L= 2090, 1911-2390, 3 ML, backset 25 mm*, lockable	-	1911-2390	S1012-21-N03		
	Gear variable L= 1610, 1431-1910, 2 ML, backset 30 mm*, lockable	-	1431-1910	S1014-16-N03		
	Gear variable L= 2090, 1911-2390, 3 ML, backset 30 mm*, lockable	-	1911-2390	S1014-21-N03		
	Gear variable L= 1610, 1431-1910, 2 ML, backset 35 mm*, lockable	-	1431-1910	S1016-16-N03		
	Gear variable L= 2090, 1911-2390, 3 ML, backset 35 mm*, lockable	-	1911-2390	S1016-21-N03		
	30	Gear variable L= 1610, 1431-1910, 2 ML, backset 25 mm	-	1431-1910	S1005-16-N03	
		Gear variable L= 2090, 1911-2390, 3 ML, backset 25 mm	-	1911-2390	S1005-21-N03	
Gear variable L= 1610, 1431-1910, 2 ML, backset 30 mm		-	1431-1910	S1007-16-N03		
Gear variable L= 2090, 1911-2390, 3 ML, backset 30 mm		-	1911-2390	S1007-21-N03		
Gear variable L= 1610, 1431-1910, 2 ML, backset 35 mm		-	1431-1910	S1009-16-N03		
Gear variable L= 2090, 1911-2390, 3 ML, backset 35 mm		-	1911-2390	S1009-21-N03		
Gear variable L= 1610, 1431-1910, 2 ML, backset 25 mm*		-	1431-1910	S1011-16-N03		
Gear variable L= 2090, 1911-2390, 3 ML, backset 25 mm*		-	1911-2390	S1011-21-N03		
Gear variable L= 1610, 1431-1910, 2 ML, backset 30 mm*		-	1431-1910	S1013-16-N03		
Gear variable L= 2090, 1911-2390, 3 ML, backset 30 mm*		-	1911-2390	S1013-21-N03		
Gear variable L= 1610, 1431-1910, 2 ML, backset 35 mm*		-	1431-1910	S1015-16-N03		
Gear variable L= 2090, 1911-2390, 3 ML, backset 35 mm*		-	1911-2390	S1015-21-N03		

FFH - sash rebate height (mm)

FFB - sash rebate width (mm)

RAB - outside width of frame (mm)

* 2-side handle

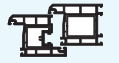

HKS 100 S, Standard, with loose post EG 15/15, width up to 750 mm

Scheme C, PVC profile

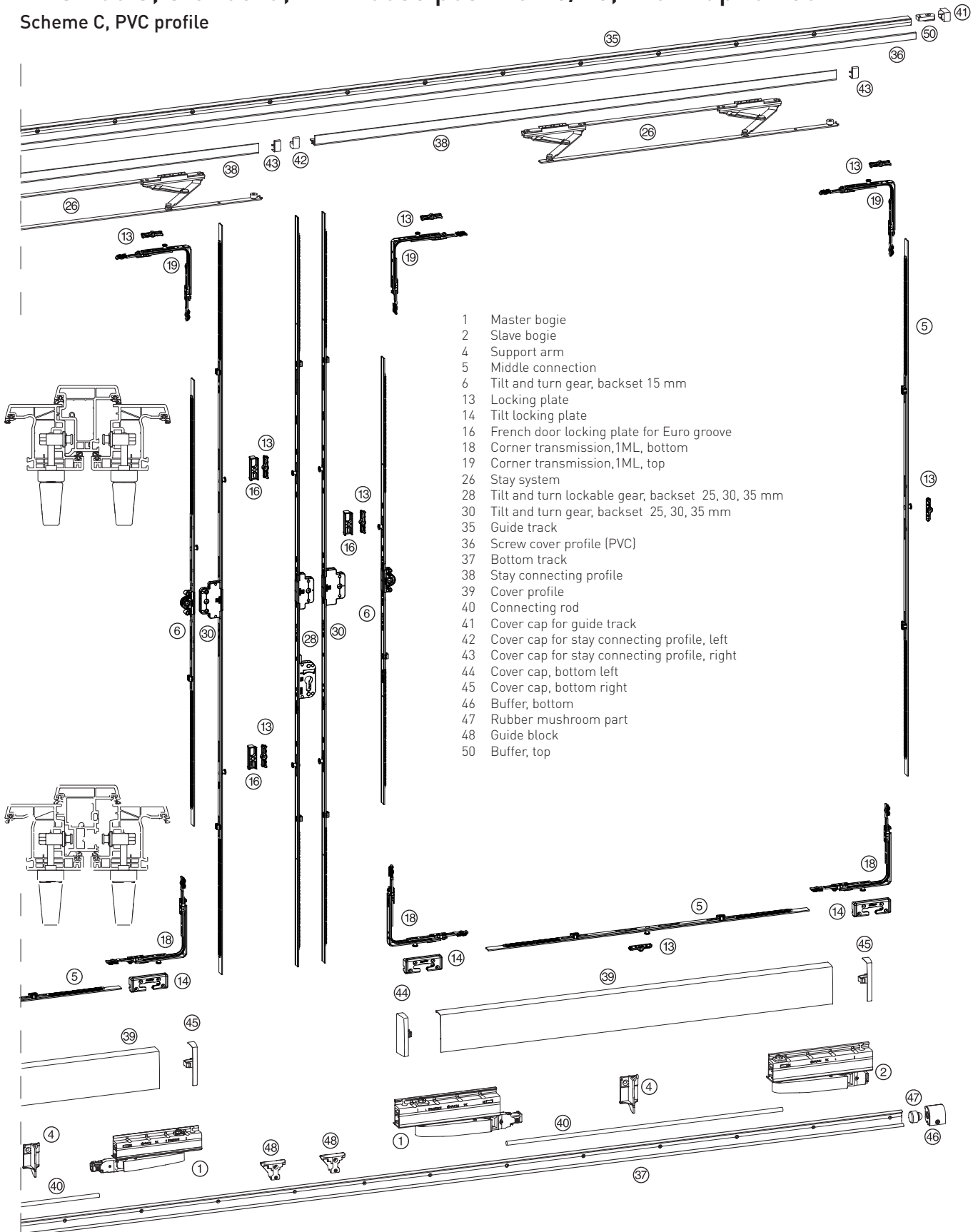

- 1 Master bogie
- 2 Slave bogie
- 4 Support arm
- 5 Middle connection
- 6 Tilt and turn gear, backset 15 mm
- 13 Locking plate
- 14 Tilt locking plate
- 16 French door locking plate for Euro groove
- 18 Corner transmission, 1ML, bottom
- 19 Corner transmission, 1ML, top
- 26 Stay system
- 28 Tilt and turn lockable gear, backset 25, 30, 35 mm
- 30 Tilt and turn gear, backset 25, 30, 35 mm
- 35 Guide track
- 36 Screw cover profile (PVC)
- 37 Bottom track
- 38 Stay connecting profile
- 39 Cover profile
- 40 Connecting rod
- 41 Cover cap for guide track
- 42 Cover cap for stay connecting profile, left
- 43 Cover cap for stay connecting profile, right
- 44 Cover cap, bottom left
- 45 Cover cap, bottom right
- 46 Buffer, bottom
- 47 Rubber mushroom part
- 48 Guide block
- 50 Buffer, top

Figure fitting parts = design left (according to DIN EN 12519 opening to the right)



HKS 100 S, Standard, with loose post EG 15/15, width up to 750 mm 750 mm

Scheme C, PVC profile

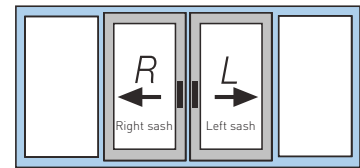

Item on the pic.		left	right		
1,2	Bogies kit HKS 100 S	I7002-00-L03	I7002-00-R03		
4, 26, 35, 36, 37, 39, 40, 41, 46, 47, 48, 50	Profile set + stay system HKS 100 S	FFB	RAB	white	brown
		620-900	1930	I7004-01-N01	I7004-01-N02
	The tying-around of a sash (vertical and horizontal locking)	FFB	FFH	Part number	
5	Middle connection L = 520	551-750	-	S4005-05-N03	
	Middle connection L = 720	751-950	-	S4005-07-N03	
	Middle connection L = 1200	951-1430	-	S4005-12-N03	
	Middle connection L = 1680	1431-1910	-	S4005-17-N03	
	Middle connection L = 2160	1911-2390	-	S4005-22-N03	
6	Gear 0, L=320, 450-550, backset 15 mm	-	450-550	S1001-02-N03	
	Gear 1, L=520, 551-750, backset 15 mm	-	551-750	S1001-04-N03	
	Gear 2, L=1000, 751-1230, 1 ML, backset 15 mm	-	751-1230	S1001-09-N03	
	Gear 3, L=1200, 950-1430, 1 ML, backset 15 mm	-	950-1430	S1001-11-N03	
	Gear 4, L=1480, 1231-1710, 2 ML, backset 15 mm	-	1231-1710	S1001-15-N03	
	Gear 5, L=1680, 1431-1910, 2 ML, backset 15 mm	-	1431-1910	S1001-16-N03	
	Gear 6, L=2160, 1911-2390, 3 ML, backset 15 mm	-	1911-2390	S1001-21-N03	
13	Locking plate	-	-	(profile-related) see profile overview	
14	Tilt locking plate	-	-	(profile-related) see profile overview	
16	French door locking plate for Euro groove	-	-	A7063-00-N03	
18	Corner transmission, bottom	400-1280	450-2390	S2006-00-N03	
19	Corner transmission standard	400-1280	450-2390	S2001-00-N03	
28	Gear variable L= 1610, 1431-1910, 2 ML, backset 25 mm, lockable	-	1431-1910	S1006-16-N03	
	Gear variable L= 2090, 1911-2390, 3 ML, backset 25 mm, lockable	-	1911-2390	S1006-21-N03	
	Gear variable L= 1610, 1431-1910, 2 ML, backset 30 mm, lockable	-	1431-1910	S1008-16-N03	
	Gear variable L= 2090, 1911-2390, 3 ML, backset 30 mm, lockable	-	1911-2390	S1008-21-N03	
	Gear variable L= 1610, 1431-1910, 2 ML, backset 35 mm, lockable	-	1431-1910	S1010-16-N03	
	Gear variable L= 2090, 1911-2390, 3 ML, backset 35 mm, lockable	-	1911-2390	S1010-21-N03	
	Gear variable L= 1610, 1431-1910, 2 ML, backset 25 mm*, lockable	-	1431-1910	S1012-16-N03	
	Gear variable L= 2090, 1911-2390, 3 ML, backset 25 mm*, lockable	-	1911-2390	S1012-21-N03	
	Gear variable L= 1610, 1431-1910, 2 ML, backset 30 mm*, lockable	-	1431-1910	S1014-16-N03	
	Gear variable L= 2090, 1911-2390, 3 ML, backset 30 mm*, lockable	-	1911-2390	S1014-21-N03	
	Gear variable L= 1610, 1431-1910, 2 ML, backset 35 mm*, lockable	-	1431-1910	S1016-16-N03	
	Gear variable L= 2090, 1911-2390, 3 ML, backset 35 mm*, lockable	-	1911-2390	S1016-21-N03	
30	Gear variable L= 1610, 1431-1910, 2 ML, backset 25 mm	-	1431-1910	S1005-16-N03	
	Gear variable L= 2090, 1911-2390, 3 ML, backset 25 mm	-	1911-2390	S1005-21-N03	
	Gear variable L= 1610, 1431-1910, 2 ML, backset 30 mm	-	1431-1910	S1007-16-N03	
	Gear variable L= 2090, 1911-2390, 3 ML, backset 30 mm	-	1911-2390	S1007-21-N03	
	Gear variable L= 1610, 1431-1910, 2 ML, backset 35 mm	-	1431-1910	S1009-16-N03	
	Gear variable L= 2090, 1911-2390, 3 ML, backset 35 mm	-	1911-2390	S1009-21-N03	
	Gear variable L= 1610, 1431-1910, 2 ML, backset 25 mm*	-	1431-1910	S1011-16-N03	
	Gear variable L= 2090, 1911-2390, 3 ML, backset 25 mm*	-	1911-2390	S1011-21-N03	
	Gear variable L= 1610, 1431-1910, 2 ML, backset 30 mm*	-	1431-1910	S1013-16-N03	
	Gear variable L= 2090, 1911-2390, 3 ML, backset 30 mm*	-	1911-2390	S1013-21-N03	
	Gear variable L= 1610, 1431-1910, 2 ML, backset 35 mm*	-	1431-1910	S1015-16-N03	
	Gear variable L= 2090, 1911-2390, 3 ML, backset 35 mm*	-	1911-2390	S1015-21-N03	



**HKS 100 S, RC1 (WK1) - RC3 (WK3), with loose post EG 15/15,
 width up to 750 mm**

Схема С, профиль: ПВХ

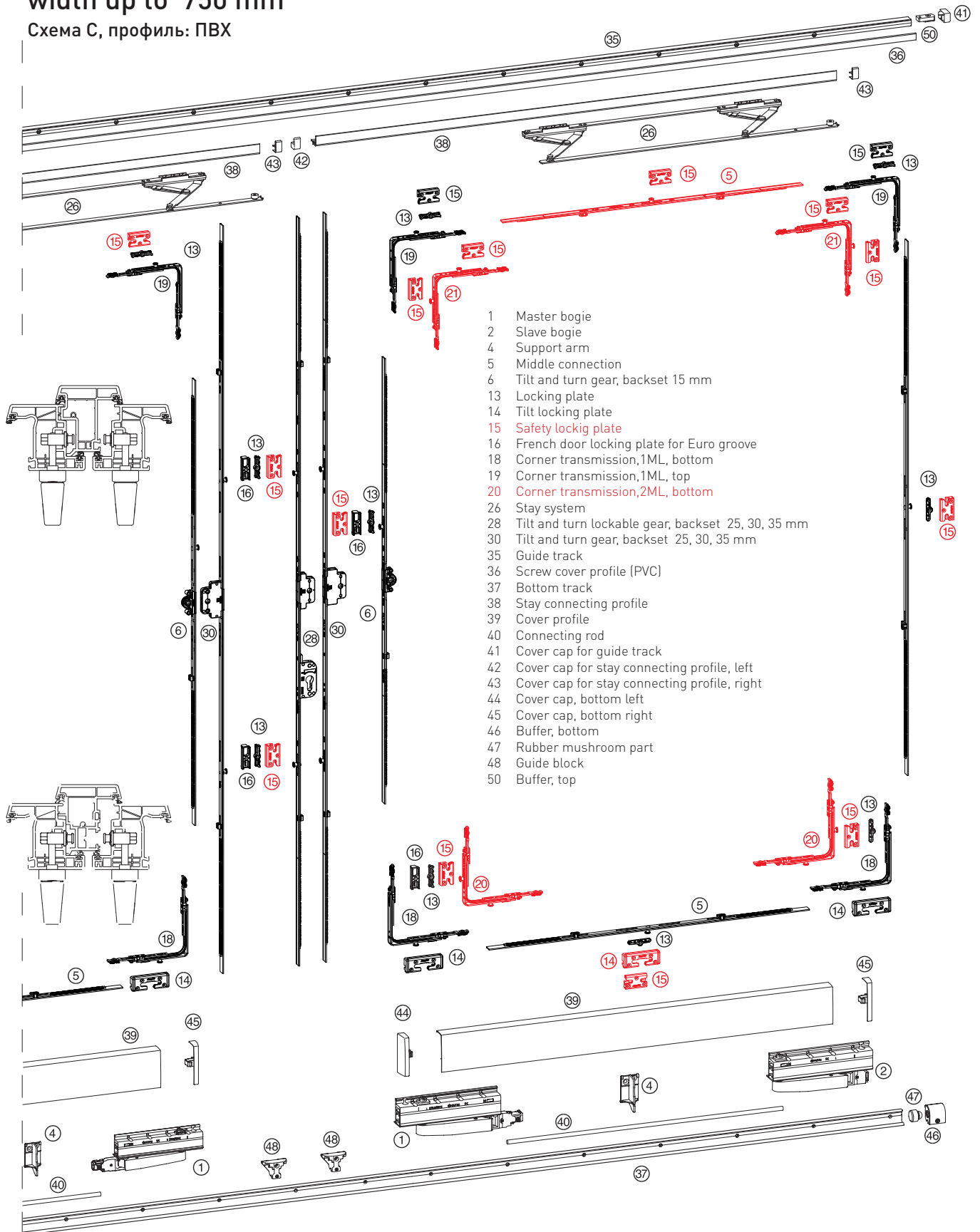
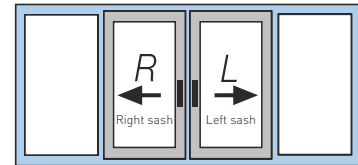

Figure fitting parts = design left (according to DIN EN 12519 opening to the right)



HKS 100 S, RC1 (WK1) - **RC3 (WK3)**, with loose post EG 15/15

Схема С, профиль: ПВХ



Item on the pic.		left	right		
1,2	Bogies kit HKS 100 S	I7002-00-L03	I7002-00-R03		
4, 26, 35, 36, 37, 39, 40, 41, 46, 47, 48, 50	Profile set + stay system HKS 100 S	FFB	RAB	white	brown
		620-900	1930	I7004-01-N01	I7004-01-N02

	The tying-around of a sash (vertical and horizontal locking)	FFB	FFH	Part number
5	Middle connection L = 520	551-750	-	S4005-05-N03
	Middle connection L = 720	751-950	-	S4005-07-N03
	Middle connection L = 1200	951-1430	-	S4005-12-N03
	Middle connection L = 1680	1431-1910	-	S4005-17-N03
	Middle connection L = 2160	1911-2390	-	S4005-22-N03
6	Gear 0, L=320, 450-550, backset 15 mm	-	450-550	S1001-02-N03
	Gear 1, L=520, 551-750, backset 15 mm	-	551-750	S1001-04-N03
	Gear 2, L=1000, 751-1230, 1 ML, backset 15 mm	-	751-1230	S1001-09-N03
	Gear 3, L=1200, 950-1430, 1 ML, backset 15 mm	-	950-1430	S1001-11-N03
	Gear 4, L=1480, 1231-1710, 2 ML, backset 15 mm	-	1231-1710	S1001-15-N03
	Gear 5, L=1680, 1431-1910, 2 ML, backset 15 mm	-	1431-1910	S1001-16-N03
	Gear 6, L=2160, 1911-2390, 3 ML, backset 15 mm	-	1911-2390	S1001-21-N03
13	Locking plate	-	-	(profile-related) see profile overview
14	Tilt locking plate	-	-	(profile-related) see profile overview
15	Safety lockig plate	-	-	(profile-related) see profile overview
16	French door locking plate for Euro groove	-	-	A7063-00-N03
18	Corner transmission, bottom	400-1280	450-2390	S2006-00-N03
19	Corner transmission standard	400-1280	450-2390	S2001-00-N03
20	Corner transmission, 2ML, bottom	400-1280	450-2390	S2007-00-N03
28	Gear variable L= 1610, 1431-1910, 2 ML, backset 25 mm, lockable	-	1431-1910	S1006-16-N03
	Gear variable L= 2090, 1911-2390, 3 ML, backset 25 mm, lockable	-	1911-2390	S1006-21-N03
	Gear variable L= 1610, 1431-1910, 2 ML, backset 30 mm, lockable	-	1431-1910	S1008-16-N03
	Gear variable L= 2090, 1911-2390, 3 ML, backset 30 mm, lockable	-	1911-2390	S1008-21-N03
	Gear variable L= 1610, 1431-1910, 2 ML, backset 35 mm, lockable	-	1431-1910	S1010-16-N03
	Gear variable L= 2090, 1911-2390, 3 ML, backset 35 mm, lockable	-	1911-2390	S1010-21-N03
	Gear variable L= 1610, 1431-1910, 2 ML, backset 25 mm*, lockable	-	1431-1910	S1012-16-N03
	Gear variable L= 2090, 1911-2390, 3 ML, backset 25 mm*, lockable	-	1911-2390	S1012-21-N03
	Gear variable L= 1610, 1431-1910, 2 ML, backset 30 mm*, lockable	-	1431-1910	S1014-16-N03
	Gear variable L= 2090, 1911-2390, 3 ML, backset 30 mm*, lockable	-	1911-2390	S1014-21-N03
	Gear variable L= 1610, 1431-1910, 2 ML, backset 35 mm*, lockable	-	1431-1910	S1016-16-N03
	Gear variable L= 2090, 1911-2390, 3 ML, backset 35 mm*, lockable	-	1911-2390	S1016-21-N03
30	Gear variable L= 1610, 1431-1910, 2 ML, backset 25 mm	-	1431-1910	S1005-16-N03
	Gear variable L= 2090, 1911-2390, 3 ML, backset 25 mm	-	1911-2390	S1005-21-N03
	Gear variable L= 1610, 1431-1910, 2 ML, backset 30 mm	-	1431-1910	S1007-16-N03
	Gear variable L= 2090, 1911-2390, 3 ML, backset 30 mm	-	1911-2390	S1007-21-N03
	Gear variable L= 1610, 1431-1910, 2 ML, backset 35 mm	-	1431-1910	S1009-16-N03
	Gear variable L= 2090, 1911-2390, 3 ML, backset 35 mm	-	1911-2390	S1009-21-N03
	Gear variable L= 1610, 1431-1910, 2 ML, backset 25 mm*	-	1431-1910	S1011-16-N03
	Gear variable L= 2090, 1911-2390, 3 ML, backset 25 mm*	-	1911-2390	S1011-21-N03
	Gear variable L= 1610, 1431-1910, 2 ML, backset 30 mm*	-	1431-1910	S1013-16-N03
	Gear variable L= 2090, 1911-2390, 3 ML, backset 30 mm*	-	1911-2390	S1013-21-N03
	Gear variable L= 1610, 1431-1910, 2 ML, backset 35 mm*	-	1431-1910	S1015-16-N03
	Gear variable L= 2090, 1911-2390, 3 ML, backset 35 mm*	-	1911-2390	S1015-21-N03



HKS 160 S, Standard, width up to 750 mm

Scheme A, PVC profile

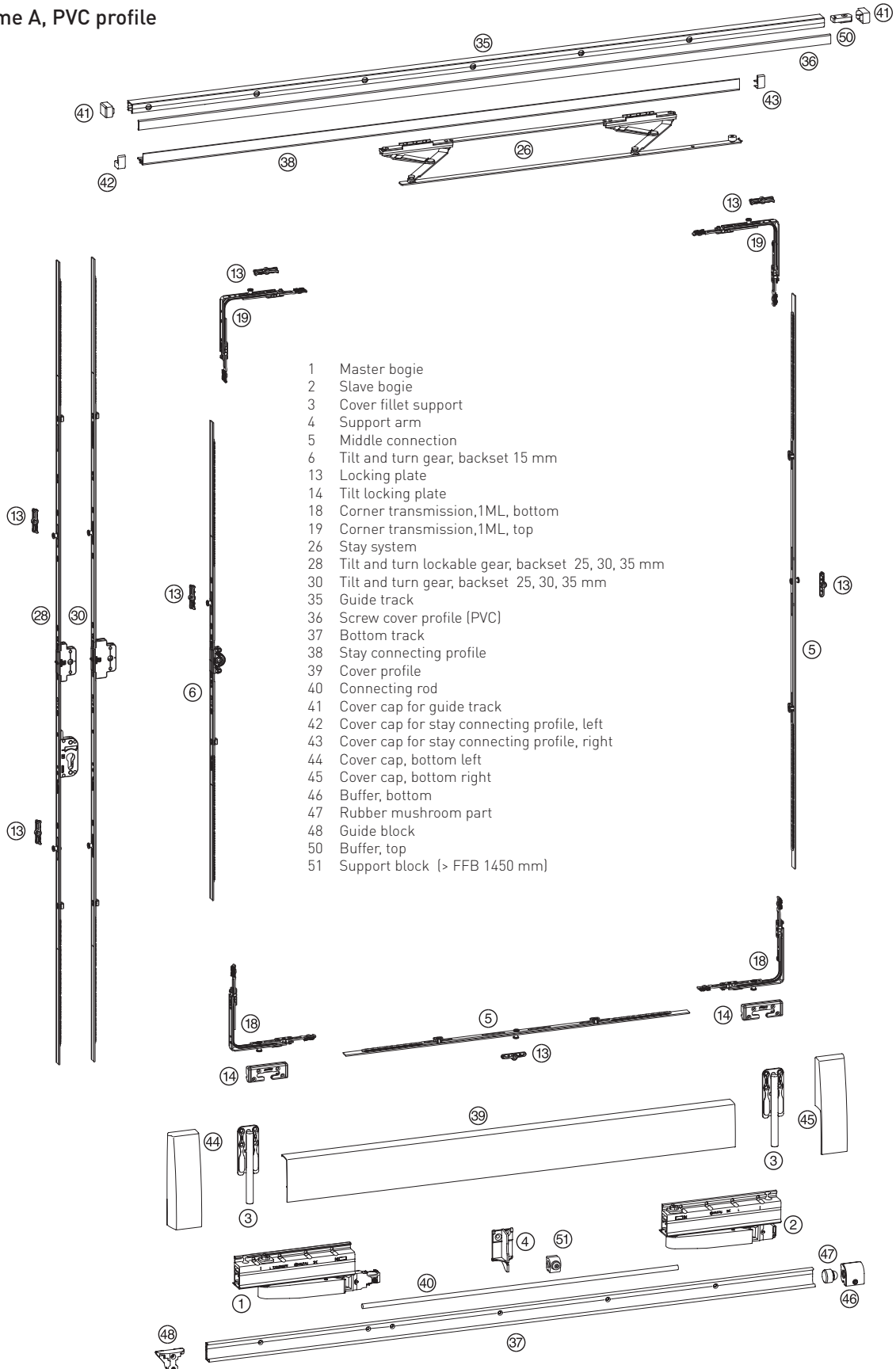

- 1 Master bogie
- 2 Slave bogie
- 3 Cover fillet support
- 4 Support arm
- 5 Middle connection
- 6 Tilt and turn gear, backset 15 mm
- 13 Locking plate
- 14 Tilt locking plate
- 18 Corner transmission, 1ML, bottom
- 19 Corner transmission, 1ML, top
- 26 Stay system
- 28 Tilt and turn lockable gear, backset 25, 30, 35 mm
- 30 Tilt and turn gear, backset 25, 30, 35 mm
- 35 Guide track
- 36 Screw cover profile (PVC)
- 37 Bottom track
- 38 Stay connecting profile
- 39 Cover profile
- 40 Connecting rod
- 41 Cover cap for guide track
- 42 Cover cap for stay connecting profile, left
- 43 Cover cap for stay connecting profile, right
- 44 Cover cap, bottom left
- 45 Cover cap, bottom right
- 46 Buffer, bottom
- 47 Rubber mushroom part
- 48 Guide block
- 50 Buffer, top
- 51 Support block (> FFB 1450 mm)

Figure fitting parts = design left (according to DIN EN 12519 opening to the right)



HKS 160 S, Standard, width up to 750 mm

Scheme A, PVC profile

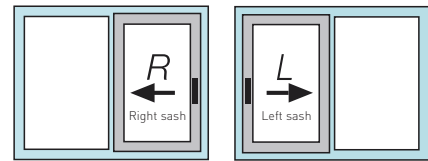

Item on the pic.		left	right				
1, 2	Bogies kit HKS 100 S	I7002-00-L03	I7002-00-R03				
		FFB	RAB	silver	white	brown	medium bronze
3, 44, 45	Cover fillet support HKS 160 S	620-900	1930	I7001-00-N03	I7001-00-N01	I7001-00-N02	I7001-00-N06
4, 35, 36, 37, 39, 40, 41, 46, 47, 48, 50	Profile set + stay system HKS 160 S			I7005-01-N03	I7004-01-N01 (stay system set is included)	I7004-01-N02 (stay system set is included)	I7005-01-N06
		FFB		silver	white	brown	medium bronze
26	Stay system	620-900		I3001-16-N03			I3001-16-N03
38, 42, 43	Stay connecting profile set HKS 160 S				I7003-01-N03		

The tying-around of a sash (vertical and horizontal locking)		FFB	FFH	Part number
5	Middle connection L = 520	551-750	-	S4005-05-N03
	Middle connection L = 720	751-950	-	S4005-07-N03
	Middle connection L = 1200	951-1430	-	S4005-12-N03
	Middle connection L = 1680	1431-1910	-	S4005-17-N03
	Middle connection L = 2160	1911-2390	-	S4005-22-N03
6	Gear 0, L=320, 450-550, backset 15 mm	-	450-550	S1001-02-N03
	Gear 1, L=520, 551-750, backset 15 mm	-	551-750	S1001-04-N03
	Gear 2, L=1000, 751-1230, 1 ML, backset 15 mm	-	751-1230	S1001-09-N03
	Gear 3, L=1200, 950-1430, 1 ML, backset 15 mm	-	950-1430	S1001-11-N03
	Gear 4, L=1480, 1231-1710, 2 ML, backset 15 mm	-	1231-1710	S1001-15-N03
	Gear 5, L=1680, 1431-1910, 2 ML, backset 15 mm	-	1431-1910	S1001-16-N03
	Gear 6, L=2160, 1911-2390, 3 ML, backset 15 mm	-	1911-2390	S1001-21-N03
13	Locking plate	-	-	(profile-related) see profile overview
14	Tilt locking plate	-	-	(profile-related) see profile overview
18	Corner transmission, bottom	400-1280	450-2390	S2006-00-N03
19	Corner transmission standard	400-1280	450-2390	S2001-00-N03
28	Gear variable L= 1610, 1431-1910, 2 ML, backset 25 mm, lockable	-	1431-1910	S1006-16-N03
	Gear variable L= 2090, 1911-2390, 3 ML, backset 25 mm, lockable	-	1911-2390	S1006-21-N03
	Gear variable L= 1610, 1431-1910, 2 ML, backset 30 mm, lockable	-	1431-1910	S1008-16-N03
	Gear variable L= 2090, 1911-2390, 3 ML, backset 30 mm, lockable	-	1911-2390	S1008-21-N03
	Gear variable L= 1610, 1431-1910, 2 ML, backset 35 mm, lockable	-	1431-1910	S1010-16-N03
	Gear variable L= 2090, 1911-2390, 3 ML, backset 35 mm, lockable	-	1911-2390	S1010-21-N03
	Gear variable L= 1610, 1431-1910, 2 ML, backset 25 mm*, lockable	-	1431-1910	S1012-16-N03
	Gear variable L= 2090, 1911-2390, 3 ML, backset 25 mm*, lockable	-	1911-2390	S1012-21-N03
	Gear variable L= 1610, 1431-1910, 2 ML, backset 30 mm*, lockable	-	1431-1910	S1014-16-N03
	Gear variable L= 2090, 1911-2390, 3 ML, backset 30 mm*, lockable	-	1911-2390	S1014-21-N03
	Gear variable L= 1610, 1431-1910, 2 ML, backset 35 mm*, lockable	-	1431-1910	S1016-16-N03
	Gear variable L= 2090, 1911-2390, 3 ML, backset 35 mm*, lockable	-	1911-2390	S1016-21-N03
30	Gear variable L= 1610, 1431-1910, 2 ML, backset 25 mm	-	1431-1910	S1005-16-N03
	Gear variable L= 2090, 1911-2390, 3 ML, backset 25 mm	-	1911-2390	S1005-21-N03
	Gear variable L= 1610, 1431-1910, 2 ML, backset 30 mm	-	1431-1910	S1007-16-N03
	Gear variable L= 2090, 1911-2390, 3 ML, backset 30 mm	-	1911-2390	S1007-21-N03
	Gear variable L= 1610, 1431-1910, 2 ML, backset 35 mm	-	1431-1910	S1009-16-N03
	Gear variable L= 2090, 1911-2390, 3 ML, backset 35 mm	-	1911-2390	S1009-21-N03
	Gear variable L= 1610, 1431-1910, 2 ML, backset 25 mm*	-	1431-1910	S1011-16-N03
	Gear variable L= 2090, 1911-2390, 3 ML, backset 25 mm*	-	1911-2390	S1011-21-N03
	Gear variable L= 1610, 1431-1910, 2 ML, backset 30 mm*	-	1431-1910	S1013-16-N03
	Gear variable L= 2090, 1911-2390, 3 ML, backset 30 mm*	-	1911-2390	S1013-21-N03
	Gear variable L= 1610, 1431-1910, 2 ML, backset 35 mm*	-	1431-1910	S1015-16-N03
	Gear variable L= 2090, 1911-2390, 3 ML, backset 35 mm*	-	1911-2390	S1015-21-N03



HKS 160 S, Standard, width up to 1250 mm

Scheme A, PVC profile

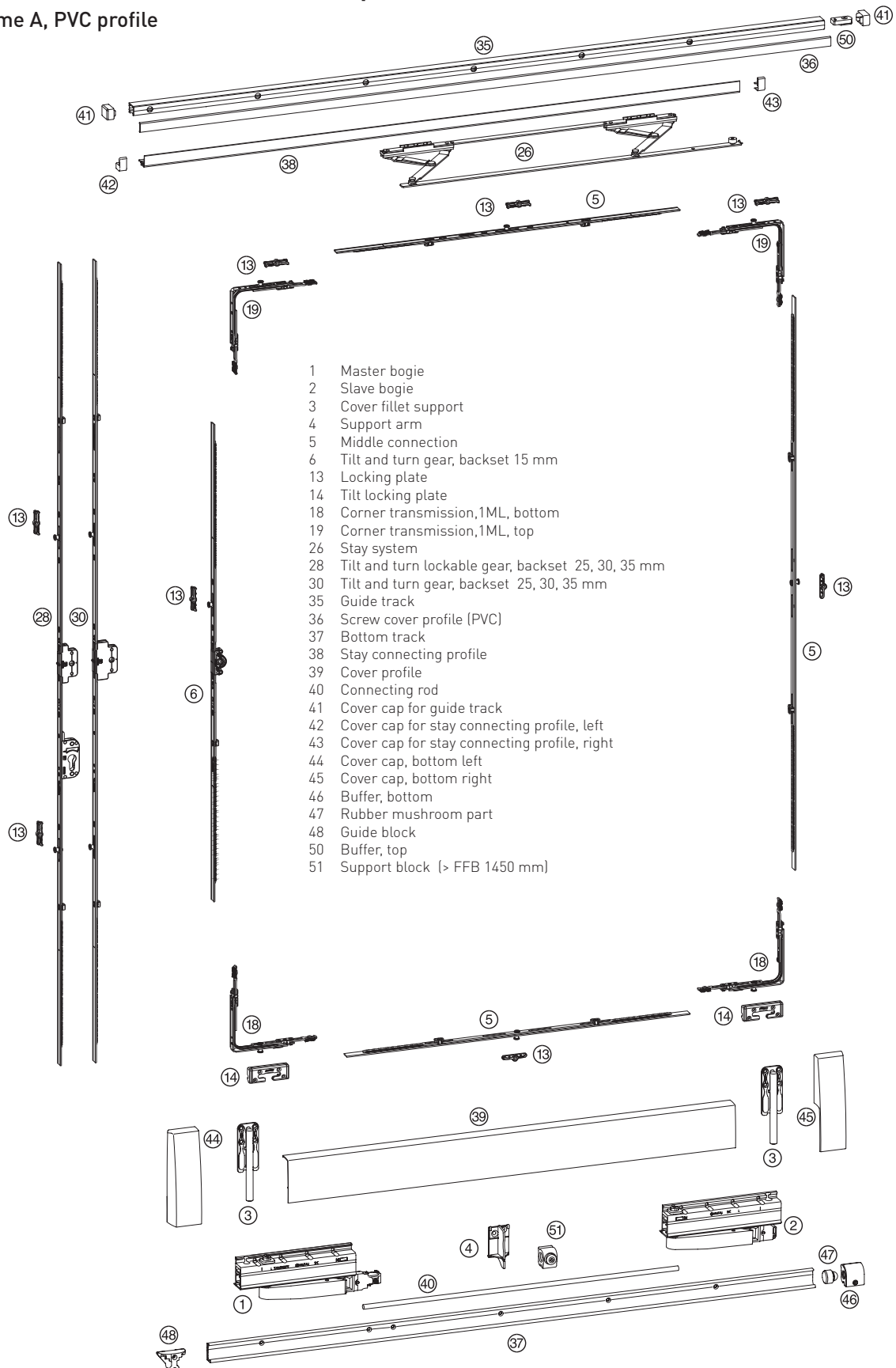
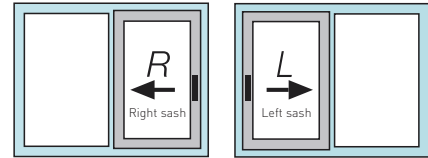

Figure fitting parts = design left (according to DIN EN 12519 opening to the right)

Accessories complete set options

HKS 160 S, Standard, width up to 1250 mm



Item on the pic.		left	right					
1, 2	Bogies kit HKS 100 S	I7002-00-L03	I7002-00-R03					
		FFB	RAB	silver	white	brown	medium bronze	
3, 44, 45	Cover fillet support HKS 160 S	620-1650	1930	I7001-00-N03	I7001-00-N01	I7001-00-N02	I7001-00-N06	
4, 35, 36, 37, 39, 40, 41, 46, 47, 48, 50	Profile set + stay system HKS 160 S	620-900	2630	I7005-01-N03	I7004-01-N01*	I7004-01-N02*	I7005-01-N06	
		901-1050		I7005-02-N03	I7004-02-N01*	I7004-02-N02*	I7005-02-N06	
		1051-1250		I7005-03-N03	I7004-03-N01*	I7004-03-N02*	I7005-03-N06	
		FFB		silver	white	brown	medium bronze	
26	Stay system	620-1650		I3001-16-N03			I3001-16-N03	
38, 42, 43	Stay connecting profile set HKS 160 S	620-1650		I7003-01-N03			I7003-01-N06	

* stay system set is included

	The tying-around of a sash (vertical and horizontal locking)	FFB	FFH	Part number	
5	Middle connection L = 520	551-750	-	S4005-05-N03	
	Middle connection L = 720	751-950	-	S4005-07-N03	
	Middle connection L = 1200	951-1430	-	S4005-12-N03	
	Middle connection L = 1680	1431-1910	-	S4005-17-N03	
	Middle connection L = 2160	1911-2390	-	S4005-22-N03	
6	Gear 0, L=320, 450-550, backset 15 mm	-	450-550	S1001-02-N03	
	Gear 1, L=520, 551-750, backset 15 mm	-	551-750	S1001-04-N03	
	Gear 2, L=1000, 751-1230, 1 ML, backset 15 mm	-	751-1230	S1001-09-N03	
	Gear 3, L=1200, 950-1430, 1 ML, backset 15 mm	-	950-1430	S1001-11-N03	
	Gear 4, L=1480, 1231-1710, 2 ML, backset 15 mm	-	1231-1710	S1001-15-N03	
	Gear 5, L=1680, 1431-1910, 2 ML, backset 15 mm	-	1431-1910	S1001-16-N03	
	Gear 6, L=2160, 1911-2390, 3 ML, backset 15 mm	-	1911-2390	S1001-21-N03	
13	Locking plate	-	-	(profile-related) see profile overview	
14	Tilt locking plate	-	-	(profile-related) see profile overview	
18	Corner transmission, bottom	400-1280	450-2390	S2006-00-N03	
19	Corner transmission standard	400-1280	450-2390	S2001-00-N03	
28	Gear variable L= 1610, 1431-1910, 2 ML, backset 25 mm, lockable	-	1431-1910	S1006-16-N03	
	Gear variable L= 2090, 1911-2390, 3 ML, backset 25 mm, lockable	-	1911-2390	S1006-21-N03	
	Gear variable L= 1610, 1431-1910, 2 ML, backset 30 mm, lockable	-	1431-1910	S1008-16-N03	
	Gear variable L= 2090, 1911-2390, 3 ML, backset 30 mm, lockable	-	1911-2390	S1008-21-N03	
	Gear variable L= 1610, 1431-1910, 2 ML, backset 35 mm, lockable	-	1431-1910	S1010-16-N03	
	Gear variable L= 2090, 1911-2390, 3 ML, backset 35 mm, lockable	-	1911-2390	S1010-21-N03	
	Gear variable L= 1610, 1431-1910, 2 ML, backset 25 mm*, lockable	-	1431-1910	S1012-16-N03	
	Gear variable L= 2090, 1911-2390, 3 ML, backset 25 mm*, lockable	-	1911-2390	S1012-21-N03	
	Gear variable L= 1610, 1431-1910, 2 ML, backset 30 mm*, lockable	-	1431-1910	S1014-16-N03	
	Gear variable L= 2090, 1911-2390, 3 ML, backset 30 mm*, lockable	-	1911-2390	S1014-21-N03	
	Gear variable L= 1610, 1431-1910, 2 ML, backset 35 mm*, lockable	-	1431-1910	S1016-16-N03	
	Gear variable L= 2090, 1911-2390, 3 ML, backset 35 mm*, lockable	-	1911-2390	S1016-21-N03	
	30	Gear variable L= 1610, 1431-1910, 2 ML, backset 25 mm	-	1431-1910	S1005-16-N03
		Gear variable L= 2090, 1911-2390, 3 ML, backset 25 mm	-	1911-2390	S1005-21-N03
Gear variable L= 1610, 1431-1910, 2 ML, backset 30 mm		-	1431-1910	S1007-16-N03	
Gear variable L= 2090, 1911-2390, 3 ML, backset 30 mm		-	1911-2390	S1007-21-N03	
Gear variable L= 1610, 1431-1910, 2 ML, backset 35 mm		-	1431-1910	S1009-16-N03	
Gear variable L= 2090, 1911-2390, 3 ML, backset 35 mm		-	1911-2390	S1009-21-N03	
Gear variable L= 1610, 1431-1910, 2 ML, backset 25 mm*		-	1431-1910	S1011-16-N03	
Gear variable L= 2090, 1911-2390, 3 ML, backset 25 mm*		-	1911-2390	S1011-21-N03	
Gear variable L= 1610, 1431-1910, 2 ML, backset 30 mm*		-	1431-1910	S1013-16-N03	
Gear variable L= 2090, 1911-2390, 3 ML, backset 30 mm*		-	1911-2390	S1013-21-N03	
Gear variable L= 1610, 1431-1910, 2 ML, backset 35 mm*		-	1431-1910	S1015-16-N03	
Gear variable L= 2090, 1911-2390, 3 ML, backset 35 mm*		-	1911-2390	S1015-21-N03	



HKS 160 S, RC1 (WK1) - RC3 (WK3), width up to 1250 mm

Scheme A, PVC profile

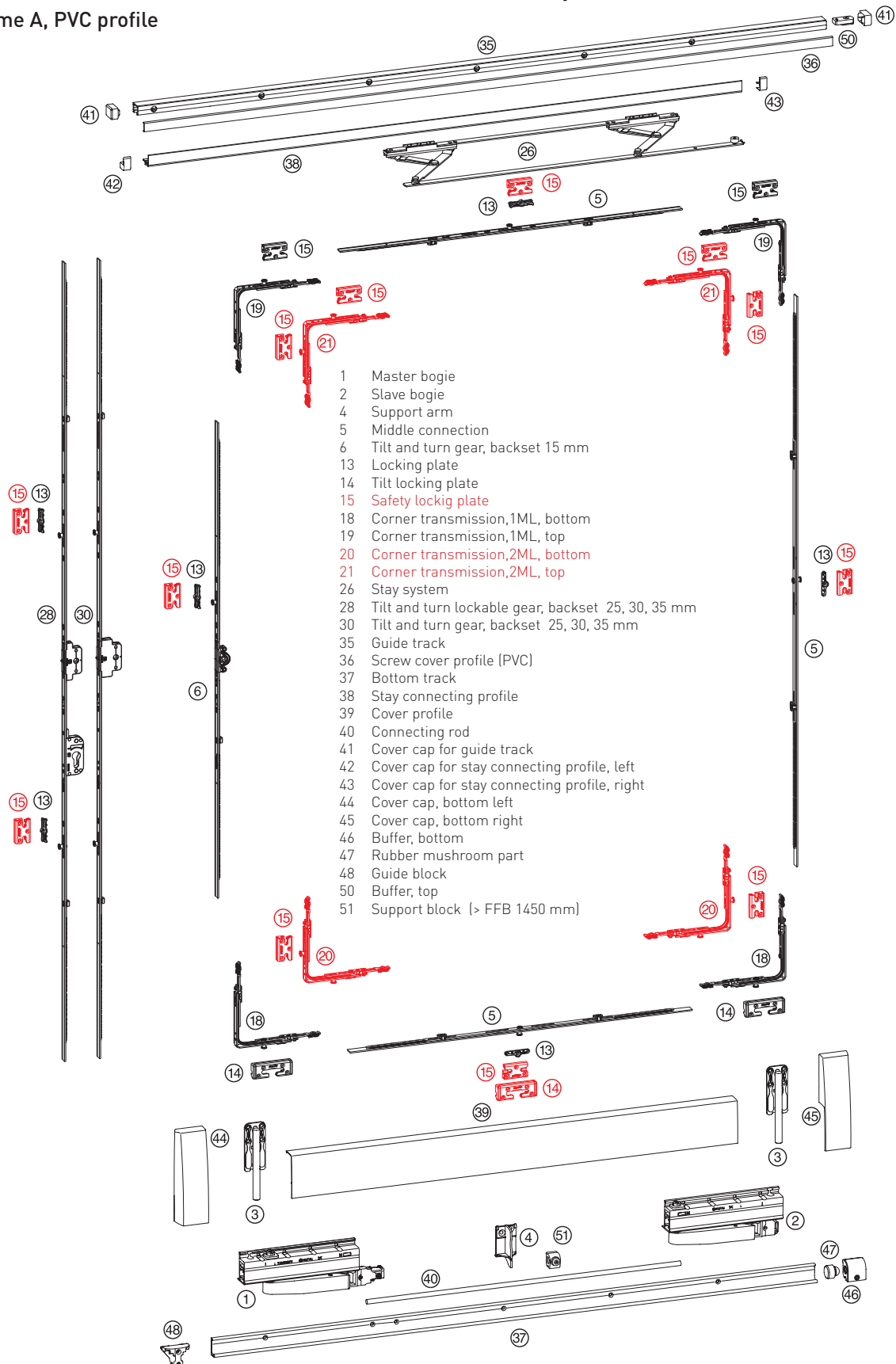
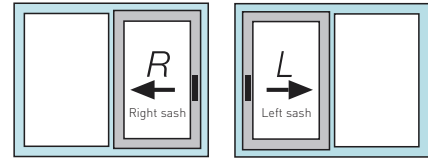

Figure fitting parts = design left (according to DIN EN 12519 opening to the right)



HKS 160 S, RC1 (WK1) - RC3 (WK3)



Item on the pic.		left	right					
1, 2	Bogies kit HKS 100 S	I7002-00-L03	I7002-00-R03					
		FFB	RAB	silver	white	brown	medium bronze	
3, 44, 45	Cover fillet support HKS 160 S	620-1650	1930	I7001-00-N03	I7001-00-N01	I7001-00-N02	I7001-00-N06	
4, 35, 36, 37, 39, 40, 41, 46, 47, 48, 50	Profile set + stay system HKS 160 S	620-900	2630	I7005-01-N03	I7004-01-N01*	I7004-01-N02*	I7005-01-N06	
		901-1050		I7005-02-N03	I7004-02-N01*	I7004-02-N02*	I7005-02-N06	
		1051-1250		I7005-03-N03	I7004-03-N01*	I7004-03-N02*	I7005-03-N06	
		FFB		silver	white	brown	medium bronze	
26	Stay system	620-1650		I3001-16-N03			I3001-16-N03	
38, 42, 43	Stay connecting profile set HKS 160 S	620-1650		I7003-01-N03			I7003-01-N06	

* stay system set is included

The tying-around of a sash (vertical and horizontal locking)		FFB	FFH	Part number
5	Middle connection L = 520	551-750	-	S4005-05-N03
	Middle connection L = 720	751-950	-	S4005-07-N03
	Middle connection L = 1200	951-1430	-	S4005-12-N03
	Middle connection L = 1680	1431-1910	-	S4005-17-N03
	Middle connection L = 2160	1911-2390	-	S4005-22-N03
6	Gear 0, L=320, 450-550, backset 15 mm	-	450-550	S1001-02-N03
	Gear 1, L=520, 551-750, backset 15 mm	-	551-750	S1001-04-N03
	Gear 2, L=1000, 751-1230, 1 ML, backset 15 mm	-	751-1230	S1001-09-N03
	Gear 3, L=1200, 950-1430, 1 ML, backset 15 mm	-	950-1430	S1001-11-N03
	Gear 4, L=1480, 1231-1710, 2 ML, backset 15 mm	-	1231-1710	S1001-15-N03
	Gear 5, L=1680, 1431-1910, 2 ML, backset 15 mm	-	1431-1910	S1001-16-N03
	Gear 6, L=2160, 1911-2390, 3 ML, backset 15 mm	-	1911-2390	S1001-21-N03
13	Locking plate	-	-	(profile-related) see profile overview
14	Tilt locking plate	-	-	(profile-related) see profile overview
15	Safety lockig plate	-	-	(profile-related) see profile overview
18	Corner transmission, bottom	400-1280	450-2390	S2006-00-N03
19	Corner transmission standard	400-1280	450-2390	S2001-00-N03
20	Corner transmission, 2ML, bottom	400-1280	450-2390	S2007-00-N03
21	Corner transmission, 2ML, top	400-1280	450-2390	S2002-00-N03
28	Gear variable L= 1610, 1431-1910, 2 ML, backset 25 mm, lockable	-	1431-1910	S1006-16-N03
	Gear variable L= 2090, 1911-2390, 3 ML, backset 25 mm, lockable	-	1911-2390	S1006-21-N03
	Gear variable L= 1610, 1431-1910, 2 ML, backset 30 mm, lockable	-	1431-1910	S1008-16-N03
	Gear variable L= 2090, 1911-2390, 3 ML, backset 30 mm, lockable	-	1911-2390	S1008-21-N03
	Gear variable L= 1610, 1431-1910, 2 ML, backset 35 mm, lockable	-	1431-1910	S1010-16-N03
	Gear variable L= 2090, 1911-2390, 3 ML, backset 35 mm, lockable	-	1911-2390	S1010-21-N03
	Gear variable L= 1610, 1431-1910, 2 ML, backset 25 mm*, lockable	-	1431-1910	S1012-16-N03
	Gear variable L= 2090, 1911-2390, 3 ML, backset 25 mm*, lockable	-	1911-2390	S1012-21-N03
	Gear variable L= 1610, 1431-1910, 2 ML, backset 30 mm*, lockable	-	1431-1910	S1014-16-N03
	Gear variable L= 2090, 1911-2390, 3 ML, backset 30 mm*, lockable	-	1911-2390	S1014-21-N03
	Gear variable L= 1610, 1431-1910, 2 ML, backset 35 mm*, lockable	-	1431-1910	S1016-16-N03
	Gear variable L= 2090, 1911-2390, 3 ML, backset 35 mm*, lockable	-	1911-2390	S1016-21-N03
30	Gear variable L= 1610, 1431-1910, 2 ML, backset 25 mm	-	1431-1910	S1005-16-N03
	Gear variable L= 2090, 1911-2390, 3 ML, backset 25 mm	-	1911-2390	S1005-21-N03
	Gear variable L= 1610, 1431-1910, 2 ML, backset 30 mm	-	1431-1910	S1007-16-N03
	Gear variable L= 2090, 1911-2390, 3 ML, backset 30 mm	-	1911-2390	S1007-21-N03
	Gear variable L= 1610, 1431-1910, 2 ML, backset 35 mm	-	1431-1910	S1009-16-N03
	Gear variable L= 2090, 1911-2390, 3 ML, backset 35 mm	-	1911-2390	S1009-21-N03
	Gear variable L= 1610, 1431-1910, 2 ML, backset 25 mm*	-	1431-1910	S1011-16-N03
	Gear variable L= 2090, 1911-2390, 3 ML, backset 25 mm*	-	1911-2390	S1011-21-N03
	Gear variable L= 1610, 1431-1910, 2 ML, backset 30 mm*	-	1431-1910	S1013-16-N03
	Gear variable L= 2090, 1911-2390, 3 ML, backset 30 mm*	-	1911-2390	S1013-21-N03
	Gear variable L= 1610, 1431-1910, 2 ML, backset 35 mm*	-	1431-1910	S1015-16-N03
	Gear variable L= 2090, 1911-2390, 3 ML, backset 35 mm*	-	1911-2390	S1015-21-N03

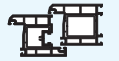

HKS 160 S, Standard, with loose post EG 15/15, width up to 750 mm
 Scheme C, PVC profile

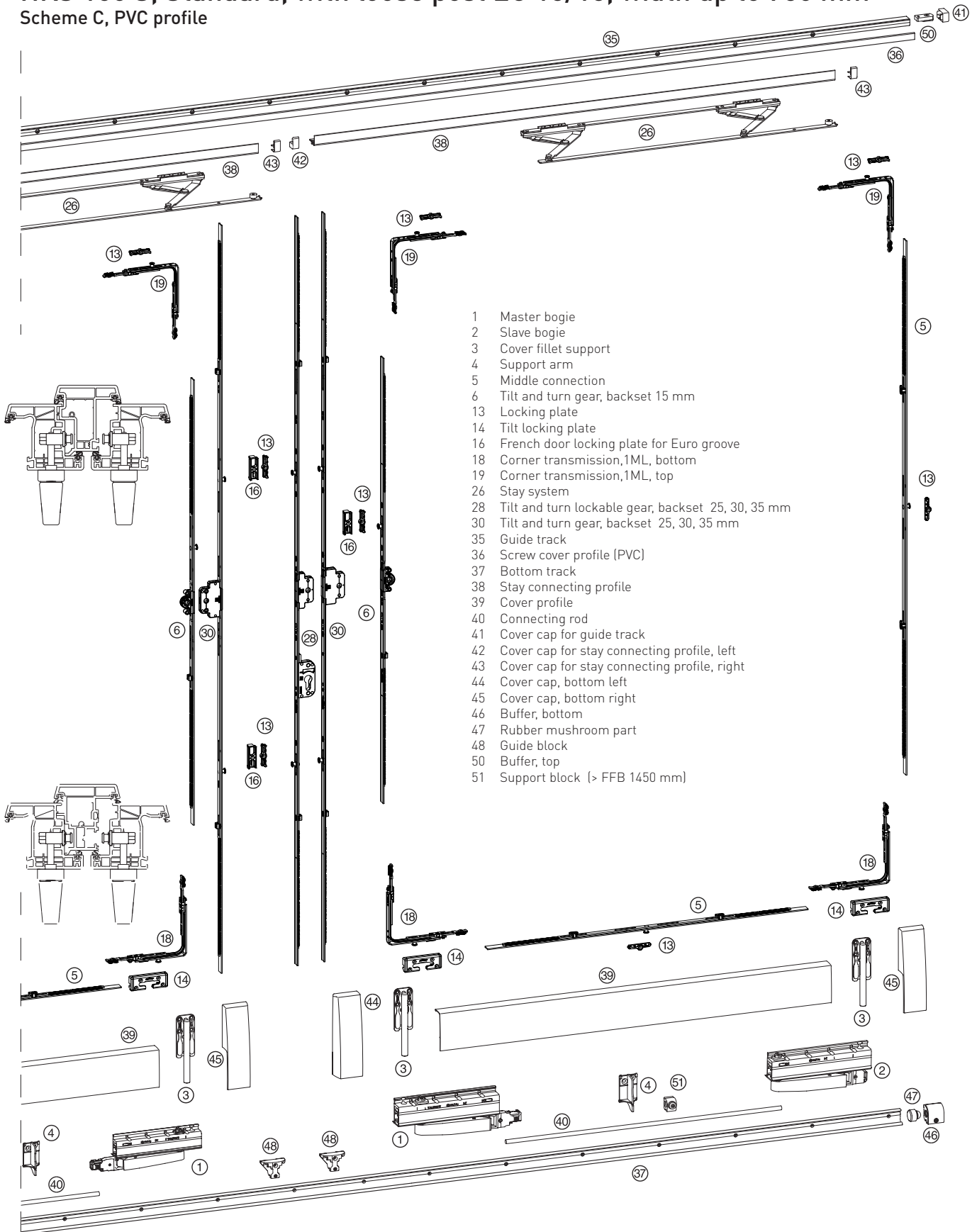

- 1 Master bogie
- 2 Slave bogie
- 3 Cover fillet support
- 4 Support arm
- 5 Middle connection
- 6 Tilt and turn gear, backset 15 mm
- 13 Locking plate
- 14 Tilt locking plate
- 16 French door locking plate for Euro groove
- 18 Corner transmission, 1ML, bottom
- 19 Corner transmission, 1ML, top
- 26 Stay system
- 28 Tilt and turn lockable gear, backset 25, 30, 35 mm
- 30 Tilt and turn gear, backset 25, 30, 35 mm
- 35 Guide track
- 36 Screw cover profile (PVC)
- 37 Bottom track
- 38 Stay connecting profile
- 39 Cover profile
- 40 Connecting rod
- 41 Cover cap for guide track
- 42 Cover cap for stay connecting profile, left
- 43 Cover cap for stay connecting profile, right
- 44 Cover cap, bottom left
- 45 Cover cap, bottom right
- 46 Buffer, bottom
- 47 Rubber mushroom part
- 48 Guide block
- 50 Buffer, top
- 51 Support block (> FFB 1450 mm)

Figure fitting parts = design left (according to DIN EN 12519 opening to the right)



HKS 160 S, Standard, with loose post EG 15/15

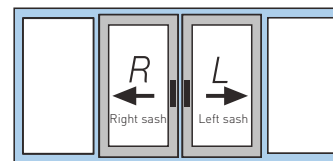

Item on the pic.		left	right				
1, 2	Bogies kit HKS 100 S	I7002-00-L03	I7002-00-R03				
		FFB	RAB	silver	white	brown	medium bronze
3, 44, 45	Cover fillet support HKS 160 S	620-900	1930	I7001-00-N03	I7001-00-N01	I7001-00-N02	I7001-00-N06
4, 35, 36, 37, 39, 40, 41, 46, 47, 48, 50	Profile set + stay system HKS 160 S			I7005-01-N03	I7004-01-N01 (stay system set is included)	I7004-01-N02 (stay system set is included)	I7005-01-N06
		FFB		silver	white	brown	medium bronze
26	Stay system	620-900		I3001-16-N03			I3001-16-N03
38, 42, 43	Stay connecting profile set HKS 160 S			I7003-01-N03			I7003-01-N06
	The tying-around of a sash (vertical and horizontal locking)			FFB	FFH		Part number
5	Middle connection L = 520			551-750	-		S4005-05-N03
	Middle connection L = 720			751-950	-		S4005-07-N03
	Middle connection L = 1200			951-1430	-		S4005-12-N03
	Middle connection L = 1680			1431-1910	-		S4005-17-N03
	Middle connection L = 2160			1911-2390	-		S4005-22-N03
6	Gear 0, L=320, 450-550, backset 15 mm			-	450-550		S1001-02-N03
	Gear 1, L=520, 551-750, backset 15 mm			-	551-750		S1001-04-N03
	Gear 2, L=1000, 751-1230, 1 ML, backset 15 mm			-	751-1230		S1001-09-N03
	Gear 3, L=1200, 950-1430, 1 ML, backset 15 mm			-	950-1430		S1001-11-N03
	Gear 4, L=1480, 1231-1710, 2 ML, backset 15 mm			-	1231-1710		S1001-15-N03
	Gear 5, L=1680, 1431-1910, 2 ML, backset 15 mm			-	1431-1910		S1001-16-N03
	Gear 6, L=2160, 1911-2390, 3 ML, backset 15 mm			-	1911-2390		S1001-21-N03
13	Locking plate			-	-		(profile-related) see profile overview
14	Tilt locking plate			-	-		(profile-related) see profile overview
16	French door locking plate for Euro groove			-	-		A7063-00-N03
18	Corner transmission, bottom			400-1280	450-2390		S2006-00-N03
19	Corner transmission standard			400-1280	450-2390		S2001-00-N03
28	Gear variable L= 1610, 1431-1910, 2 ML, backset 25 mm, lockable			-	1431-1910		S1006-16-N03
	Gear variable L= 2090, 1911-2390, 3 ML, backset 25 mm, lockable			-	1911-2390		S1006-21-N03
	Gear variable L= 1610, 1431-1910, 2 ML, backset 30 mm, lockable			-	1431-1910		S1008-16-N03
	Gear variable L= 2090, 1911-2390, 3 ML, backset 30 mm, lockable			-	1911-2390		S1008-21-N03
	Gear variable L= 1610, 1431-1910, 2 ML, backset 35 mm, lockable			-	1431-1910		S1010-16-N03
	Gear variable L= 2090, 1911-2390, 3 ML, backset 35 mm, lockable			-	1911-2390		S1010-21-N03
	Gear variable L= 1610, 1431-1910, 2 ML, backset 25 mm*, lockable			-	1431-1910		S1012-16-N03
	Gear variable L= 2090, 1911-2390, 3 ML, backset 25 mm*, lockable			-	1911-2390		S1012-21-N03
	Gear variable L= 1610, 1431-1910, 2 ML, backset 30 mm*, lockable			-	1431-1910		S1014-16-N03
	Gear variable L= 2090, 1911-2390, 3 ML, backset 30 mm*, lockable			-	1911-2390		S1014-21-N03
	Gear variable L= 1610, 1431-1910, 2 ML, backset 35 mm*, lockable			-	1431-1910		S1016-16-N03
	Gear variable L= 2090, 1911-2390, 3 ML, backset 35 mm*, lockable			-	1911-2390		S1016-21-N03
30	Gear variable L= 1610, 1431-1910, 2 ML, backset 25 mm			-	1431-1910		S1005-16-N03
	Gear variable L= 2090, 1911-2390, 3 ML, backset 25 mm			-	1911-2390		S1005-21-N03
	Gear variable L= 1610, 1431-1910, 2 ML, backset 30 mm			-	1431-1910		S1007-16-N03
	Gear variable L= 2090, 1911-2390, 3 ML, backset 30 mm			-	1911-2390		S1007-21-N03
	Gear variable L= 1610, 1431-1910, 2 ML, backset 35 mm			-	1431-1910		S1009-16-N03
	Gear variable L= 2090, 1911-2390, 3 ML, backset 35 mm			-	1911-2390		S1009-21-N03
	Gear variable L= 1610, 1431-1910, 2 ML, backset 25 mm*			-	1431-1910		S1011-16-N03
	Gear variable L= 2090, 1911-2390, 3 ML, backset 25 mm*			-	1911-2390		S1011-21-N03
	Gear variable L= 1610, 1431-1910, 2 ML, backset 30 mm*			-	1431-1910		S1013-16-N03
	Gear variable L= 2090, 1911-2390, 3 ML, backset 30 mm*			-	1911-2390		S1013-21-N03
	Gear variable L= 1610, 1431-1910, 2 ML, backset 35 mm*			-	1431-1910		S1015-16-N03
	Gear variable L= 2090, 1911-2390, 3 ML, backset 35 mm*			-	1911-2390		S1015-21-N03



HKS 160 S, RC1 (WK1) - RC3 (WK3), with loose post EG 15/15,
 width up to 750 mm

Scheme C, PVC profile

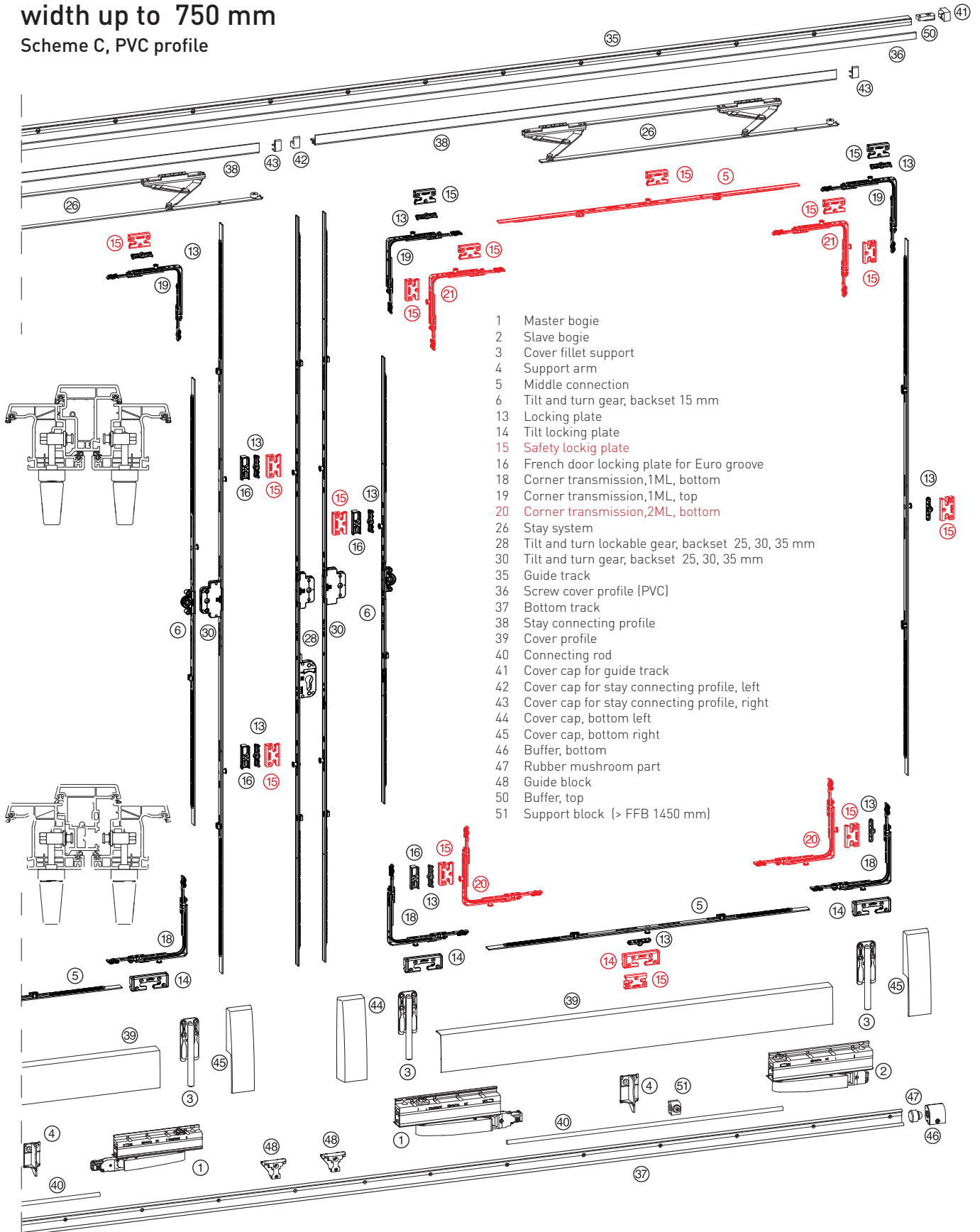

- 1 Master bogie
- 2 Slave bogie
- 3 Cover fillet support
- 4 Support arm
- 5 Middle connection
- 6 Tilt and turn gear, backset 15 mm
- 13 Locking plate
- 14 Tilt locking plate
- 15 Safety locking plate
- 16 French door locking plate for Euro groove
- 18 Corner transmission, 1ML, bottom
- 19 Corner transmission, 1ML, top
- 20 Corner transmission, 2ML, bottom
- 26 Stay system
- 28 Tilt and turn lockable gear, backset 25, 30, 35 mm
- 30 Tilt and turn gear, backset 25, 30, 35 mm
- 35 Guide track
- 36 Screw cover profile (PVC)
- 37 Bottom track
- 38 Stay connecting profile
- 39 Cover profile
- 40 Connecting rod
- 41 Cover cap for guide track
- 42 Cover cap for stay connecting profile, left
- 43 Cover cap for stay connecting profile, right
- 44 Cover cap, bottom left
- 45 Cover cap, bottom right
- 46 Buffer, bottom
- 47 Rubber mushroom part
- 48 Guide block
- 50 Buffer, top
- 51 Support block (> FFB 1450 mm)

Figure fitting parts = design left (according to DIN EN 12519 opening to the right)



HKS 160 S, RC1 (WK1) - RC3 (WK3)

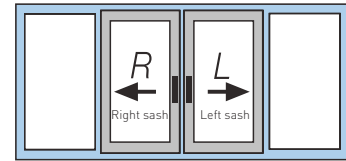

Item on the pic.		left	right				
1, 2	Bogies kit HKS 100 S	I7002-00-L03	I7002-00-R03				
		FFB	RAB	silver	white	brown	medium bronze
3, 44, 45	Cover fillet support HKS 160 S	620-900	1930	I7001-00-N03	I7001-00-N01	I7001-00-N02	I7001-00-N06
4, 35, 36, 37, 39, 40, 41, 46, 47, 48, 50	Profile set + stay system HKS 160 S			I7005-01-N03	I7004-01-N01 (stay system set is included)	I7004-01-N02 (stay system set is included)	I7005-01-N06
		FFB		silver	white	brown	medium bronze
26	Stay system	620-900		I3001-16-N03			I3001-16-N03
38, 42, 43	Stay connecting profile set HKS 160 S			I7003-01-N03			I7003-01-N06
	The tying-around of a sash (vertical and horizontal locking)			FFB	FFH		Part number
5	Middle connection L = 520			551-750	-		S4005-05-N03
	Middle connection L = 720			751-950	-		S4005-07-N03
	Middle connection L = 1200			951-1430	-		S4005-12-N03
	Middle connection L = 1680			1431-1910	-		S4005-17-N03
	Middle connection L = 2160			1911-2390	-		S4005-22-N03
6	Gear 0, L=320, 450-550, backset 15 mm			-	450-550		S1001-02-N03
	Gear 1, L=520, 551-750, backset 15 mm			-	551-750		S1001-04-N03
	Gear 2, L=1000, 751-1230, 1 ML, backset 15 mm			-	751-1230		S1001-09-N03
	Gear 3, L=1200, 950-1430, 1 ML, backset 15 mm			-	950-1430		S1001-11-N03
	Gear 4, L=1480, 1231-1710, 2 ML, backset 15 mm			-	1231-1710		S1001-15-N03
	Gear 5, L=1680, 1431-1910, 2 ML, backset 15 mm			-	1431-1910		S1001-16-N03
	Gear 6, L=2160, 1911-2390, 3 ML, backset 15 mm			-	1911-2390		S1001-21-N03
13	Locking plate			-	-		(profile-related) see profile overview
14	Tilt locking plate			-	-		(profile-related) see profile overview
15	Safety lockig plate			-	-		(profile-related) see profile overview
16	French door locking plate for Euro groove			-	-		A7063-00-N03
18	Corner transmission, bottom			400-1280	450-2390		S2006-00-N03
19	Corner transmission standard			400-1280	450-2390		S2001-00-N03
20	Corner transmission, 2ML, bottom			400-1280	450-2390		S2007-00-N03
28	Gear variable L= 1610, 1431-1910, 2 ML, backset 25 mm, lockable			-	1431-1910		S1006-16-N03
	Gear variable L= 2090, 1911-2390, 3 ML, backset 25 mm, lockable			-	1911-2390		S1006-21-N03
	Gear variable L= 1610, 1431-1910, 2 ML, backset 30 mm, lockable			-	1431-1910		S1008-16-N03
	Gear variable L= 2090, 1911-2390, 3 ML, backset 30 mm, lockable			-	1911-2390		S1008-21-N03
	Gear variable L= 1610, 1431-1910, 2 ML, backset 35 mm, lockable			-	1431-1910		S1010-16-N03
	Gear variable L= 2090, 1911-2390, 3 ML, backset 35 mm, lockable			-	1911-2390		S1010-21-N03
	Gear variable L= 1610, 1431-1910, 2 ML, backset 25 mm*, lockable			-	1431-1910		S1012-16-N03
	Gear variable L= 2090, 1911-2390, 3 ML, backset 25 mm*, lockable			-	1911-2390		S1012-21-N03
	Gear variable L= 1610, 1431-1910, 2 ML, backset 30 mm*, lockable			-	1431-1910		S1014-16-N03
	Gear variable L= 2090, 1911-2390, 3 ML, backset 30 mm*, lockable			-	1911-2390		S1014-21-N03
	Gear variable L= 1610, 1431-1910, 2 ML, backset 35 mm*, lockable			-	1431-1910		S1016-16-N03
	Gear variable L= 2090, 1911-2390, 3 ML, backset 35 mm*, lockable			-	1911-2390		S1016-21-N03
30	Gear variable L= 1610, 1431-1910, 2 ML, backset 25 mm			-	1431-1910		S1005-16-N03
	Gear variable L= 2090, 1911-2390, 3 ML, backset 25 mm			-	1911-2390		S1005-21-N03
	Gear variable L= 1610, 1431-1910, 2 ML, backset 30 mm			-	1431-1910		S1007-16-N03
	Gear variable L= 2090, 1911-2390, 3 ML, backset 30 mm			-	1911-2390		S1007-21-N03
	Gear variable L= 1610, 1431-1910, 2 ML, backset 35 mm			-	1431-1910		S1009-16-N03
	Gear variable L= 2090, 1911-2390, 3 ML, backset 35 mm			-	1911-2390		S1009-21-N03
	Gear variable L= 1610, 1431-1910, 2 ML, backset 25 mm*			-	1431-1910		S1011-16-N03
	Gear variable L= 2090, 1911-2390, 3 ML, backset 25 mm*			-	1911-2390		S1011-21-N03
	Gear variable L= 1610, 1431-1910, 2 ML, backset 30 mm*			-	1431-1910		S1013-16-N03
	Gear variable L= 2090, 1911-2390, 3 ML, backset 30 mm*			-	1911-2390		S1013-21-N03
	Gear variable L= 1610, 1431-1910, 2 ML, backset 35 mm*			-	1431-1910		S1015-16-N03
	Gear variable L= 2090, 1911-2390, 3 ML, backset 35 mm*			-	1911-2390		S1015-21-N03

Profile name	B	Locking plate	Safety locking plate	Tilt safety locking plate
ALUPLAST IDEAL 2000	13	A7012-13-N03	S6001-13-N03	S6002-13-N03
BROKELMANN 58	13	A7034-13-N00	S6005-13-N03	S6006-13-N03
BROKELMANN 70	13	A7012-13-N03	S6005-13-N03	S6006-13-N03
DECEUNINCK	13	A7044-13-N03	S6012-13-N03	S6013-13-N03
GEALAN	13	A7042-13-N03	S6014-13-N03	S6022-13-L/R03
GEALAN 9000N		A7066-13-N03		
KBE 58/9	9	A7013-09-N03	S6003-09-N03	S6004-09-N03
KBE 58/9 Plus	9	A7043-09-N03	S6003-09-N03	S6004-09-N03
KBE 58/13	13	A7011-13-N03	S6001-13-N03	S6002-13-N03
KONING 70	13	A7012-13-N03	S6005-13-N03	S6006-13-N03
MIROPLAST WDS 400	13	A7011-13-N03	S6001-13-N03	S6002-13-N03
MIROPLAST WDS 404	13	A7011-13-N03	S6001-13-N03	S6002-13-N03
MIROPLAST WDS 505	13	A7011-13-N03	S6001-13-N03	S6002-13-N03
MIROPLAST WDS 800	13	A7011-13-N03	S6001-13-N03	S6002-13-N03
REHAU BASIC DESIGN	13	A7012-13-N03	S6001-13-N03	S6002-13-N03
REHAU BRILLANT DESIGN	13	A7012-13-N03	S6001-13-N03	S6002-13-N03
REHAU CLIMA DESIGN	13	A7012-13-N03	S6001-13-N03	S6002-13-N03
REHAU THERMO DESIGN	13	A7012-13-N03	S6001-13-N03	S6002-13-N03
SALAMANDER DESIGN 2D	13	A7012-13-N03	S6001-13-N03	S6002-13-N03
SALAMANDER DESIGN 3D	13	A7012-13-N03	S6001-13-N03	S6002-13-N03
VEKA SOFTLINE 58	13	A7011-13-N03	S6001-13-N03	S6002-13-N03
VEKA SOFTLINE 70	13	A7011-13-N03	S6001-13-N03	S6002-13-N03
VEKA ВерхняяLINE AD	13	A7011-13-N03	S6001-13-N03	S6002-13-N03
WINTECH 532 (ISOTECH)	13	A7011-13-N03	S6007-13-N03	S6008-13-N03
WINTECH 632	13	A7011-13-N03	S6001-13-N03	S6002-13-N03
WINTECH 742	13	A7011-13-N03	S6001-13-N03	S6002-13-N03
WINTECH 752	13	A7011-13-N03	S6001-13-N03	S6002-13-N03
WINTECH 80	13	A7011-13-N03	S6001-13-N03	S6002-13-N03
French door locking plate for Euro groove		A7063-00-N03		